



Special Pricing Valid Through March 31, 2024



**Purchase a Boring Bar Kit
And receive a pack of inserts to suit**

Made in Taiwan

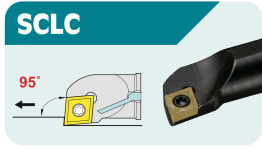

CCMT Non-Coolant Bars

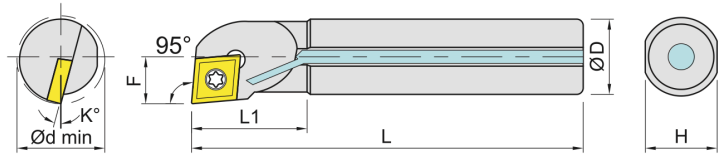

Part Number	Description	L Dimension	D Dimension	Price	Insert
329-IS05KSCLCR2B	IS05K-SCLCR-2-B	5"	5/16"	\$79	CCMT 0602/ CCMT 21.5
329-IS06KSCLCR2B	IS06K-SCLCR-2-B	5"	3/8"	\$79	
329-IS08MSCLCR2	IS08M-SCLCR-2	6"	1/2"	\$79	
329-IS08MSCLCR3	IS08M-SCLCR-3	6"	1/2"	\$79	CCMT 09T3/ CCMT 32.5
329-IS10QSCLCR3B	IS10Q-SCLCR-3-B	7"	5/8"	\$79	
329-IS12RSCLCR3	IS12R-SCLCR-3	8"	3/4"	\$89	
329-IS16RSCLCR3	IS16R-SCLCR-3	8"	1"	\$99	

CCMT Coolant Through Bars

Part Number	Description	L Dimension	D Dimension	Price	Insert
329-IA12RSCLCR3	IA12R-SCLCR-3	8"	3/4"	\$129	CCMT 09T3/ CCMT 32.5
329-IA16RSCLCR3	IA16R-SCLCR-3	8"	1"	\$149	

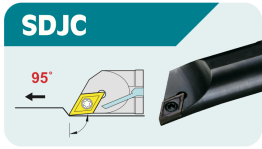

DCMT Non-Coolant Face Profiling Bars

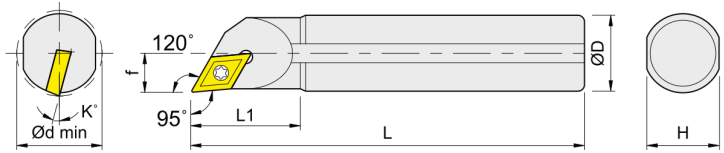

Part Number	Description	L Dimension	D Dimension	Price	Insert
329-IS06KSDJCR2	IS06K-SDJCR-2	5"	3/8"	\$79	DCMT 0702/ DCMT 21.5
329-IS10QSDJCR2	IS10Q-SDJCR-2	7"	5/8"	\$79	
329-IS12RSDJCR3	IS12R-SDJCR-3	8"	3/4"	\$89	DCMT 11T3/ 32.5

AVAILABLE INSERTS

INSERT	STAINLESS GRADE CX2545	STEEL GRADE CX2555/60	INSERT	STAINLESS GRADE CX2545	STEEL GRADE CX2555/60
CCMT 060202-MG		●	DCMT 070202-MG	●	●
CCMT 060204-MG	●	●	DCMT 070204-MG	●	●
CCMT 060204-MP		●	DCMT 11T304-MG	●	●
CCMT 09T304-MG	●	●	DCMT 11T304-MP		●
CCMT 09T304-MP		●	DCMT 11T308-MG	●	●
CCMT 09T308-MG	●	●	DCMT 11T308-MP		●
CCMT 09T308-MP		●			

RIGHT HAND BARS ONLY



5500 Tomken Rd, Unit #2
Mississauga, ON L4W 2Z4
www.caliberindustrial.com
sales@caliberindustrial.com

Mississauga: 905.624.5524
Toronto: 416.626.7151
Toll Free: 1.800.465.5743
Fax: 905.602.8758