



WINTER 2024 PROMOTIONS

Mississauga ... 905.624.5524
 Toronto 416.626.7151
 Toll Free 1.800.465.5743
www.caliberindustrial.com
sales@caliberindustrial.com



**Special Pricing Expires
 April 30, 2024**



**Coolant Through
 Drill & Tap Kit**



WALTER Engineering Kompetenz
TC117/TC217 Advance Cutting Taps
OXIDE (WY80FC)

Tap Size	DRILL EDP#	Drill Size	Decimal	Tap EDP# Spiral Flute	KIT PRICE	Tap EDP# Spiral Point	KIT PRICE
#8-32	DC150-05-03.500A1-WJ30RE	3.5mm	.1378"	146-7557035	\$66.55	146-7557173	\$64.44
#10-24	DC150-05-03.900A1-WJ30RE	3.9mm	.1535"	146-7557036	\$68.35	146-7557174	\$66.07
#10-32	DC150-05-04.100A1-WJ30RE	4.1mm	.1614"	146-7557095	\$70.90	146-7557205	\$68.35
1/4"-20	DC150-05-05.200A1-WJ30RE	5.2mm	.2047"	146-7557037	\$71.98	146-7557175	\$69.35
1/4"-28	DC150-05-05.556A1-WJ30RE	7/32"	.2187"	146-7557096	\$74.85	146-7557206	\$71.98
5/16"-18	DC150-05-06.747A1-WJ30RE	17/64"	.2656"	146-7557038	\$87.58	146-7557176	\$84.27
5/16"-24	DC150-05-07.000A1-WJ30RE	7mm	.2756"	146-7557097	\$91.17	146-7557207	\$87.58
3/8"-16	DC150-05-08.100A1-WJ30RE	8.1mm	.3189"	146-7557039	\$103.74	146-7557177	\$99.63
3/8"-24	DC150-05-08.600A1-WJ30RE	8.6mm	.3386"	146-7557098	\$107.73	146-7557208	\$103.74
7/16"-14	DC150-05-09.525A1-WJ30RE	3/8"	.3750"	146-7557040	\$107.33	146-7557178	\$102.94
7/16"-20	DC150-05-10.000A1-WJ30RE	10mm	.3937"	146-7557099	\$111.72	146-7557209	\$107.33
1/2"-13	DC150-05-11.000A1-WJ30RE	11mm	.4331"	146-7557041	\$134.86	146-7557179	\$127.68
1/2"-20	DC150-05-11.600A1-WJ30RE	11.6mm	.4567"	146-7557100	\$140.05	146-7557210	\$134.86
5/8"-11	DC150-05-13.900A1-WJ30RE	13.9mm	.5472"	146-7557042	\$179.95	146-7557180	\$173.57
5/8"-18	DC150-05-14.700A1-WJ30RE	14.7mm	.5787"	146-7557102	\$221.45	146-7557212	\$214.66
3/4"-10	DC150-05-16.750A1-WJ30RE	16.75mm	.6594"	146-7557043	\$276.11	146-7557181	\$267.73
3/4"-16	DC150-05-17.700A1-WJ30RE	17.7mm	.6969"	146-7557103	\$285.29	146-7557213	\$276.11
M 4x.7	DC150-05-03.400A1-WJ30RE	3.4mm	.1338"	146-7557143	\$66.55	146-7557226	\$64.44
M 5x.8	DC150-05-04.300A1-WJ30RE	4.3mm	.1693"	146-7557144	\$68.35	146-7557227	\$66.07
M 6x1	DC150-05-05.159A1-WJ30RE	13/64"	.2031"	146-7557145	\$71.98	146-7557228	\$69.35
M 8x1.25	DC150-05-06.900A1-WJ30RE	6.9mm	.2716"	146-7557146	\$87.58	146-7557229	\$84.27
M 10x1.5	DC150-05-08.700A1-WJ30RE	8.7mm	.3425"	146-7557147	\$103.74	146-7557230	\$99.63
M 12x1.75	DC150-05-10.500A1-WJ30RE	10.5mm	.4133"	146-7557148	\$134.86	146-7557231	\$127.68
M 16x2	DC150-05-14.288A1-WJ30RE	9/16"	.5625"	146-7557149	\$214.66	146-7557232	\$208.28
M 20x2.5	DC150-05-17.800A1-WJ30RE	17.8mm	.7007"	146-7557150	\$276.11	146-7557233	\$267.73

OR

SCAN Here

* Tap drill sizes are a guideline only based on average commercial work (65-70% thread).

Ref. No 109-2402-1C



ACE Spot Drill

Your NEW Spotting Concept!

Dual Clamping Screwed Design
Ensures the vibration free during the cutting



Excellent Repeatability. No Need For Re-setting Tool Length By Insert Type.
High Rigidity, High Performance Cutting, Ultra-long Tool Life.

Inserts **NEW**

NC2057: Universal grade for alloy steel and cast iron. Each insert has 2 cutting edges.

NC5254: For stainless steel. Each insert has 2 cutting edges.

XP9000: High positive geometry and sharp edge produces excellent surface finish.

For non-ferrous material such as aluminum, titanium, brass, copper and long cutting chip metal. Each insert has 2 cutting edges.

**Buy 1 Tool Holder
& Receive 1 Insert
FREE OF CHARGE**

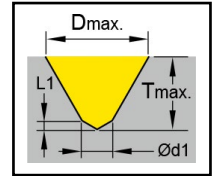
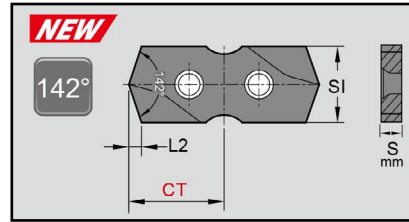
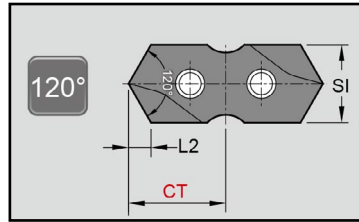
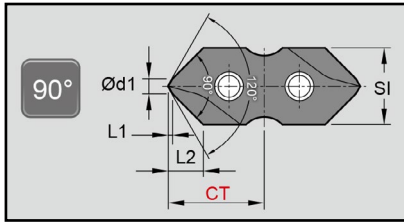

SI	Angle ±0.5	Code	Parts No.	Coating	Grade	Dimensions			Dmax.	Tmax.	S	CT ±0.025	PRICE	
						Ød1	L1	L2						
06	90°	06A031	S9MT06T1-090	NC2057	P35	1.2	0.35	2.75	5.5	2.5	1.8	7.5	\$50.00	
		06A033		NC5254									Helica	\$50.00
		06A032		XP9000									Uncoated	\$50.00
	120°	06A041	S9MT06T1-120	NC2057	P35	-	-	1.73	5.5	1.6	1.8	7.5	\$50.00	
		06A043		NC5254									Helica	\$50.00
		06A042		XP9000									Uncoated	\$50.00
	142°	06A051	S9MT06T1-142	NC2057	P35	-	-	1.03	5.5	0.95	1.8	7.0	\$50.00	
		06A053		NC5254									Helica	\$50.00
		06A052		XP9000									Uncoated	\$50.00
08	90°	06A131	S9MT0802-090	NC2057	P35	1.6	0.46	3.6	7.5	3.4	2.4	10	\$59.00	
		06A135		NC5254									Helica	\$59.00
		06A132		XP9000									Uncoated	\$59.00
	120°	06A141	S9MT0802-120	NC2057	P35	-	-	2.3	7.5	2.2	2.4	10	\$59.00	
		06A143		NC5254									Helica	\$59.00
		06A142		XP9000									Uncoated	\$59.00
	142°	06A151	S9MT0802-142	NC2057	P35	-	-	1.38	7.5	1.29	2.4	9	\$59.00	
		06A153		NC5254									Helica	\$59.00
		06A152		XP9000									Uncoated	\$59.00
10	90°	06A231	S9MT1003-090	NC2057	P35	2	0.58	4.6	9.5	4.4	3.0	12.50	\$77.00	
		06A233		NC5254									Helica	\$77.00
		06A232		XP9000									Uncoated	\$77.00
	120°	06A241	S9MT1003-120	NC2057	P35	-	-	2.9	9.5	2.7	3.0	12.50	\$77.00	
		06A243		NC5254									Helica	\$77.00
		06A242		XP9000									Uncoated	\$77.00
	142°	06A251	S9MT1003-142	NC2057	P35	-	-	1.72	9.5	1.64	3.0	11.50	\$77.00	
		06A253		NC5254									Helica	\$77.00
		06A252		XP9000									Uncoated	\$77.00
12	90°	06A331	S9MT1203-090	NC2057	P35	2.4	0.69	5.5	11.5	5.3	3.0	15	\$93.00	
		06A333		NC5254									Helica	\$93.00
		06A332		XP9000									Uncoated	\$93.00
	120°	06A341	S9MT1203-120	NC2057	P35	-	-	3.5	11.5	3.3	3.0	15	\$93.00	
		06A343		NC5254									Helica	\$93.00
		06A342		XP9000									Uncoated	\$93.00
	142°	06A351	S9MT1203-142	NC2057	P35	-	-	2.07	11.5	1.98	3.0	13.5	\$93.00	
		06A353		NC5254									Helica	\$93.00
		06A352		XP9000									Uncoated	\$93.00



Winter 2024 Promotions

Celebrating 50 Years in Business

----- 1974-2024 -----



SI	Angle ±0.5	Code	Parts No.	Coating	Grade	Dimensions			Dmax.	Tmax.	S	CT ±0.025	PRICE	
						Ød1	L1	L2						
16	90°	06A431	S9MT1603-090	NC2057	P35	3.2	0.92	7.3	15.5	7.0	3.18	20	AlTiN+TiSiN	\$137.00
		06A433		NC5254									Helica	\$137.00
		06A432		XP9000									Uncoated	\$137.00
	120°	06A441	S9MT1603-120	NC2057	P35	-	-	4.6	15.5	4.4	3.18	20	AlTiN+TiSiN	\$137.00
		06A443		NC5254									Helica	\$137.00
		06A442		XP9000									Uncoated	\$137.00
	142°	06A451	S9MT1603-142	NC2057	P35	-	-	2.76	15.5	2.67	3.18	18	AlTiN+TiSiN	\$137.00
		06A453		NC5254									Helica	\$137.00
		06A452		XP9000									Uncoated	\$137.00
20	90°	06A531	S9MT2004-090	NC2057	P35	4.0	1.16	9.2	19.5	8.9	4.76	25	AlTiN+TiSiN	\$247.00
		06A533		NC5254									Helica	\$247.00
		06A532		XP9000									Uncoated	\$247.00
	120°	06A541	S9MT2004-120	NC2057	P35	-	-	5.8	19.5	5.6	4.76	25	AlTiN+TiSiN	\$247.00
		06A543		NC5254									Helica	\$247.00
		06A542		XP9000									Uncoated	\$247.00
	142°	06A551	S9MT2004-142	NC2057	P35	-	-	3.44	19.5	3.36	4.76	22	AlTiN+TiSiN	\$247.00
		06A553		NC5254									Helica	\$247.00
		06A552		XP9000									Uncoated	\$247.00

* 60° spotting inserts are available on request.

Cylindrical Shank

NEW

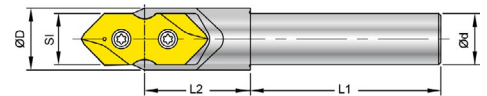
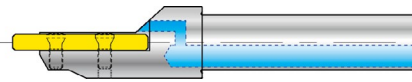

Made of hardened high alloy steel, 53 HRC. Internal coolant.

SI	Code	Parts No.	Ød	L1	L2	ØD	Screw	Key	PRICE
06	6A0001	00-99688-SI06-06	6	27	14	8	*NS-18037 / 0.6Nm	NK-T6	\$209.00
08	6A0101	00-99688-SI08-08	8	36	19	10.5	*NS-20045 / 0.6Nm	NK-T6	\$229.00
10	6A0201	00-99688-SI10-10	10	40	22.5	13	*NS-25060 / 0.9Nm	NK-T7	\$255.00
12	6A0301	00-99688-SI12-12	12	45	25	15.5	NS-30072 / 2.0Nm	NK-T9	\$255.00
16	6A0401	00-99688-SI16-16	16	48	32	21	NS-35080 / 2.5Nm	NK-T15	\$340.00
20	6A0501	00-99688-SI20-20	20	50	35	26	NS-50125 / 5.5Nm	NK-T20	\$425.00

* Torque screwdriver is recommended.

Screw Fit Cutter

NEW

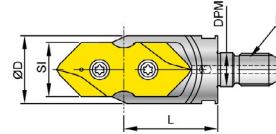

Made of hardened high alloy steel, 53 HRC. Internal coolant.

SI	Code	Parts No.	Ød	L	M	DPM	Screw	Key	PRICE
06	6A2001	00-99688-SI06-M04	8	14.5	M4xP0.7	4.5	*NS-18037 / 0.6Nm	NK-T6	\$214.04
08	6A2101	00-99688-SI08-M05	10	19	M5xP0.8	5.5	*NS-20045 / 0.6Nm	NK-T6	\$234.31
10	6A2201	00-99688-SI10-M06	12	22	M6xP1.0	6.5	*NS-25060 / 0.9Nm	NK-T7	\$260.25
12	6A2301	00-99688-SI12-M08	16	25	M8xP1.25	8.5	NS-30072 / 2.0Nm	NK-T9	\$260.25
16	6A2401	00-99688-SI16-M10	20	31	M10xP1.5	10.5	NS-35080 / 2.5Nm	NK-T15	\$347.00
20	6A2501	00-99688-SI20-M12	25	35	M12xP1.75	12.5	NS-50125 / 5.5Nm	NK-T20	\$433.76

* Torque screwdriver is recommended.

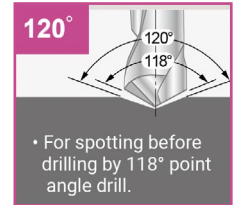
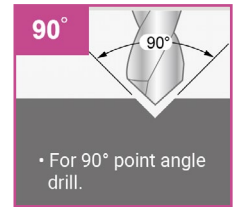

See Pages 8-9 for Carbide Shanks



NC Spot Drill

One tool performs multiple applications!



Insert Code	Part	Coating	Dmax.	Tmax.	Holder Code	Part		
013401	N9MT080208CT	NC40	10	4.5	603001	99616-10 Ø10		
013402	N9MT080204CT	NC40				TiN	613001	99616-3/8 Ø3/8"
013403		NC10				TiAlN		
014401	N9MT11T3CT	NC40	14	7	604004	99616-14 Ø16		
014402		NC10				TiAlN	614002	99616-14 Ø5/8"

PROMO

BUY 10 INSERTS
GET 1 HOLDER

Free

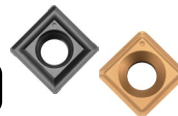

Winter 2024 Promotions

Celebrating 50 Years in Business

----- 1974-2024 -----





**Buy 10 Inserts
Get Body FREE**
MIX & MATCH Option

Deburring Mill

Specialized on narrow space
Below 10mm by indexable inserts

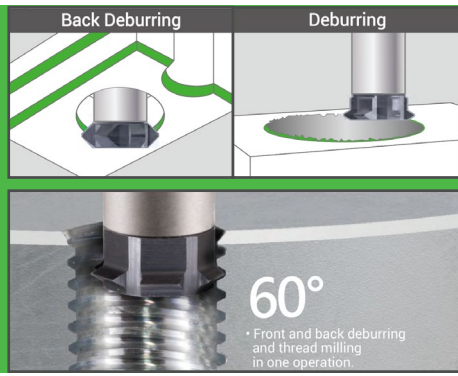

60° Deburring Mill Inserts **NEW**

- For front and back deburring.
- Also for threading application.

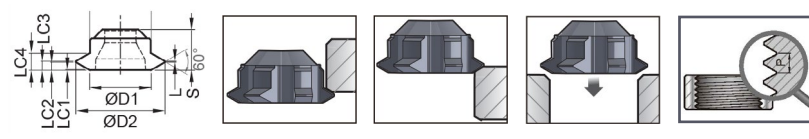

Code	Parts No.	Coating	Grade	ØD1	ØD2	L	LC1	LC2	LC3	LC4	S	Plunge 0.1C		Pitch Range		PRICE
												min.hole	max.hole	mm	TPI	
01R2101	R06005-05006-32	TiAlN	K20F	3.9	5.0	0.06	0.03	0.35	0.41	2.45	2.45	4.1	4.8	0.7-0.75	28-24	\$35.00
01R2102	R06005-05006-00	Uncoated														\$35.00
01R2103	R06005-05010-32	TiAlN		3.9	5.0	0.1	0.03	0.32	0.42	2.45	2.45	4.1	4.8	0.8-1.0	28-24	\$35.00
01R2104	R06005-05010-00	Uncoated														\$35.00
01R2301	R06007-06810-32	TiAlN		5.5	6.8	0.1	0.03	0.40	0.50	3.25	3.25	5.7	6.6	0.8-1.25	20	\$38.00
01R2302	R06007-06810-00	Uncoated														\$38.00
01R2601	R06010-08510-32	TiAlN		6.9	8.5	0.1	0.03	0.49	0.59	4.60	4.60	7.1	8.3	1.0-1.5	18-16	\$41.00
01R2602	R06010-08510-00	Uncoated														\$41.00
01R2603	R06010-10010-32	TiAlN	6.9	10.0	0.1	0.03	0.92	1.02	4.60	4.60	7.1	9.8	1.0-2.0	14-9	\$41.00	
01R2604	R06010-10010-00	Uncoated													\$41.00	

90° Deburring Mill Inserts **NEW**

- Front & back deburring in one operation.

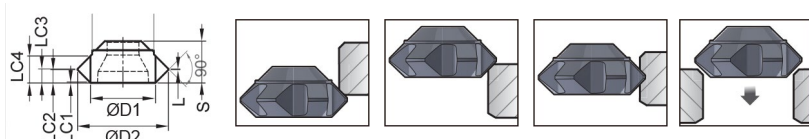

Code	Parts No.	Coating	Grade	ØD1	ØD2	L	LC1	LC2	LC3	LC4	S	Plunge 0.1C		PRICE
												min.hole	max.hole	
01R4101	R09005-05060-32	TiAlN	K20F	3.9	5.0	0.6	0.05	0.6	1.2	1.77	2.45	4.1	4.8	\$35.00
01R4102	R09005-05060-00	Uncoated												\$35.00
01R4301	R09007-07020-32	TiAlN		5.1	7.0	0.2	0.05	1.0	1.2	2.17	3.25	5.3	6.8	\$38.00
01R4302	R09007-07020-00	Uncoated												\$38.00
01R4601	R09010-10010-32	TiAlN		7.2	10.0	0.1	0.05	1.45	1.55	2.97	4.60	7.4	9.8	\$41.00
01R4602	R09010-10010-00	Uncoated												\$41.00

Holders **NEW**

- Made of hardened high alloy steel.
- For both 60° and 90° deburring inserts.

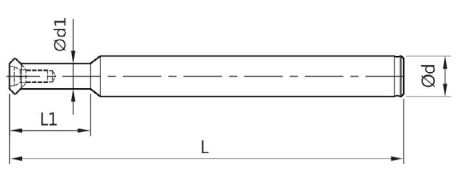

Code	Parts No.	Type	Ød	Ød1	L1	L	Insert Type	Screw	Key	PRICE
70R102	00-99626-CR05-05-031	BC05-CR05-031	5	3.5	6 (1xD)	31	Rxxx05	*NS-20045 0.6Nm	NK-T6	\$119.00
70R103	00-99626-CR05-08-076	BC08-CR05-076	8	3.5	12 (2xD)	76				\$119.00
70R101	00-99626-CR05-05-043	BC05-CR05-043	5	3.5	18 (3xD)	43				\$119.00
70R302	00-99626-CR07-06-036	BC06-CR07-036	6	5	8	36	Rxxx07	NS-25060 0.9Nm	NK-T7	\$119.00
70R303	00-99626-CR07-08-078	BC08-CR07-078	8	5	16	78				\$119.00
70R301	00-99626-CR07-06-052	BC06-CR07-052	6	5	24	52				\$119.00
70R602	00-99626-CR10-08-040	BC08-CR10-040	8	6.8	10	40	Rxxx10	NS-35080 2.5Nm	NK-T15	\$119.00
70R603	00-99626-CR10-08-082	BC08-CR10-082	8	6.8	20	82				\$119.00
70R601	00-99626-CR10-08-070	BC08-CR10-070	8	6.8	30	70				\$119.00



**PURCHASE A BAR AND
A HEAD TO SUIT
AND
CHOOSE A 2ND HEAD
FREE OF CHARGE!**

Goodbye, vibrations!

Imagine a world without vibration. It would make your life easier, right? Eliminating vibration in machining completely is not possible. But with our machining tool holders, you can reduce vibration in machining substantially.

Say hello to MAQ's self-tuning mass damper™.

MASS DAMPENING BORING BARS

feature a polymer based technology to instantly tune out vibration when boring at extended lengths. When the vibrations hit the polymer that supports the mass dampener inside the boring bar it changes its properties to tune out the vibration. The leading competitors feature an oil based system which over time breaks down or leaks making the bar less effective.

Latest Innovation

EDP	Description	Diameter	Length	DCON	SALE Price
330-300566*	STMD I 5/16-4.7 SDQCR C	5/16"	0.94	-	\$797.09
330-300387*	STMD I 5/16-4.7 SCLCR C	5/16"	0.94	-	\$797.09
330-300392*	STMD I 3/8-5.9 SDUCR C	3/8"	1.18	-	\$840.57
330-300393*	STMD I 3/8-5.9 SCLCR C	3/8"	1.18	-	\$840.57
330-300040	STMDI 1/2-5.7"	1/2"	5.7"	SL12	\$785.49
330-300041	STMDI 5/8-6.7"	5/8"	6.7"	SL16	\$1,028.97
330-300050	STMDI 5/8-8.0"	5/8"	8.0"	SL16	\$1,740.55
330-300042	STMDI 3/4-7.9"	3/4"	7.9"	SL20	\$1,202.88
330-300051	STMDI 3/4-10.3"	3/4"	10.3"	SL20	\$1,970.98
330-300043	STMDI 1.00-10"	1"	10"	SL25	\$1,257.95
330-300052	STMDI 1.00-13.2"	1"	13.2"	SL25	\$1,898.52
330-300044	STMDI 1-1/4-12.6"	1-1/4"	12.6"	SL32	\$1,284.04
330-300053	STMDI 1-1/4-16.4"	1-1/4"	16.4"	SL32	\$2,136.19
330-300045	STMDI 1-1/2-16"	1-1/2"	16"	SL40	\$1,817.36
330-300054	STMDI 1-1/2-20.8"	1-1/2"	20.8"	SL40	\$2,927.49
330-300046	STMDI 2.00-20.4-SL40	2"	20.4"	SL40	\$2,514.45
330-300055	STMDI 2.00-26.0-SL40	2"	26.0"	SL40	\$3,718.78

* Straight holder (8-12xD) with fixed cutter heads (Inch)

Curious?

Scan QR Code
To Learn More!

OR



Latest Innovation

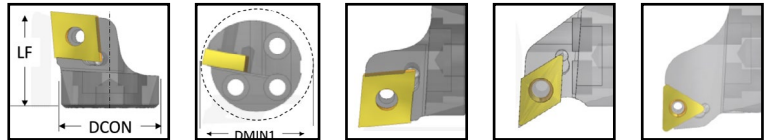

DCON	DMIN	LF (CCMT Dimn. in brackets)	CCMT Heads	SALE Price	DCMT Heads	SALE Price	TCMT Heads	SALE Price
SL12	0.629"	0.551" (0.565")	SCLCR-12-1/2 330-300071	\$146.37	SDUCR-12-1/2 330-300059	\$146.37	STFCR-12-1/2 330-300065	\$156.52
SL16	0.790"	0.629" (0.605")	SCLCR-16-5/8 330-300072	\$159.42	SDUCR-16-5/8 330-300060	\$152.17	STFCR-16-5/8 330-300066	\$162.32
SL20	0.984"	0.790" (0.752")	SCLCR-20-3/4 330-300073	\$169.56	SDUCR-20-3/4 330-300061	\$159.42	STFCR-20-3/4 330-300067	\$162.32
SL25	1.259"	0.870" (0.830")	SCLCR-25-1 330-300074	\$184.05	SDUCR-25-1 330-300062	\$163.77	STFCR-25-1 330-300068	\$169.56
SL32	1.575"	1.062" (0.950")	SCLCR-32-1-1/4 330-300075	\$201.45	SDUCR-32-1-1/4 330-300063	\$173.91	STFCR-32-1-1/4 330-300069	\$173.91
SL40	1.968" *	1.260" (0.990")	SCLCR-40-1-1/2 330-300196	\$334.78	SDUCR-40-1-1/2 330-300064	\$201.45	STFCR-40-1-1/2 330-300070	\$201.45

* When used on 1-1/2" bar.





Winter 2024 Promotions

Celebrating 50 Years in Business
----- 1974-2024 -----

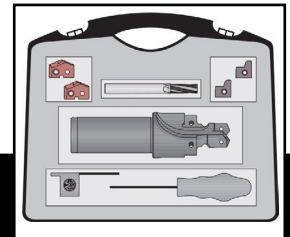
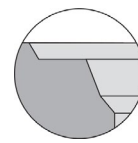
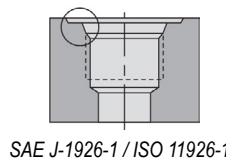



Tube Dash No.	AccuPort 432 for STEEL/FERROUS Materials			GEN2 T-A® Insert 		Port Form Insert 		AccuThread™ Thread Mill 		Kit Part No.	KIT PRICE
	Part No.	Port Thread Size	QTY	Super Cobalt (AM200®)	QTY	C5 Carbide (TiAlN)	QTY	Part No. (AM210®)	QTY		
-4	J1926-04Y-063F	7/16-20 UNF-2B	1	45YH-.386	2	J1926-02-C5A	2	TMAK0438-20	1	ATKK04-1926	\$768.63
-5	J1926-05Z-063F	1/2-20 UNF-2B	1	45ZH-11.5	2	J1926-03-C5A	2	TMAK0438-20	1	ATKK05-1926	\$768.63
-6	J1926-06O-075F	9/16-18 UNF-2B	1	45OH-13	2	J1926-03-C5A	2	TMAK0563-18	1	ATKK06-1926	\$789.49
-8	J1926-08O-075F	3/4-16 UNF-2B	1	45OH-0022	2	J1926-07-C5A	2	TMAK0750-16	1	ATKK08-1926	\$789.49
-10	J1926-10I-100F	7/8-14 UNF-2B	1	45IH-20.5	2	J1926-04-C5A	2	TMAK0875-14	1	ATKK10-1926	\$809.15
-12	J1926-12Z-125F	1-1/16-12 UN-2B	1	452H-25	2	J1926-08-C5A	2	TMAK1063-12	1	ATKK12-1926	\$858.01
-14	J1926-14Z-125F	1-3/16-12 UN-2B	1	452H-28	2	J1926-08-C5A	2	TMAK1063-12	1	ATKK14-1926	\$872.91
-16	J1926-16Z-125F	1-5/16-12 UN-2B	1	452H-1.231	2	J1926-09-C5A	2	TMAK1063-12	1	ATKK16-1926	\$894.96
-20	J1926-203-150F	1-5/8-12 UN-2B	1	453H-39	1	J1926-10-C5A	2	TMAK1063-12	1	ATKK20-1926	\$902.10
-24	J1926-243-150F	1-7/8-12 UN-2B	1	453H-45.5	1	J1926-11-C5A	2	TMAK1063-12	1	ATKK24-1926	\$928.91
-32	J1926-324-150F	2-1/2-12 UN-2B	1	454H-61.5	1	J1926-12-C5A	2	TMAK1063-12	1	ATKK32-1926	\$1049.28

AccuPort 432® - Product Overview

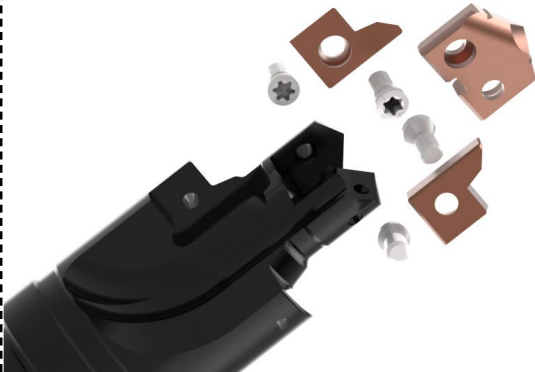

ONE Tool | FOUR Operations

* As designers and manufacturing engineers push the limits of production technology to improve productivity and performance, Allied Machine has continued to innovate and develop new solutions like the unique AccuPort 432 hydraulic port contour cutter system. Allied's revolutionary port hole drilling system performs multiple operations **in a single step**. The patented design provides excellent repeatability and surface finish while eliminating lost production time due to pre-drilling setups and regrinding.

* Hydraulic systems are present in an incredibly diverse range of industries. Anywhere a hydraulic port is required, AccuPort can provide a more cost-effective and higher performance solution in a fraction of the time taken for traditional methods using separate drills, special forming tools, and spot facers.



Aerospace
Pumps
Landing Gear
Brake Cylinders
Manifolds



Agriculture
Pumps
Manifolds
Cylinders and Rams
Gear Pumps



Automotive
Motor Valves
Relief Valves
Brake Cylinders
Power Steering Pumps



Marine/Shipbuilding
Pumps
Cylinders and Rams
Motors
Manifolds

Port Specifications



Imperial
SAE J-1926
ISO 11926-1
MS-16142



Extended minor diameter length option also available



Metric
ISO 6149-1:2006
SAE J-2244/1



Holders made with ID ridge
Utilizes inserts with or without ID ridge



Military
SAE AS5202

Also conforms to AND10050 specification by using an alternate tap drill size for a UN thread

**** Non-standard port tools available upon request through Allied's engineering department ****

TV-6 & TV-8 Vises

Versatile machine vises with large opening capacity

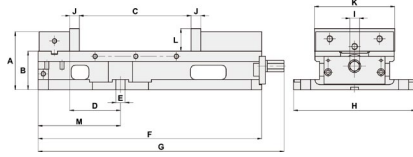

SPECIFICATIONS (Material: FCD 60 Ductile Iron. Hardness: HRC 50°)

Unit: mm

Model	A	B	C	D	E	F	G	H	I
TV-6" Super-Open 10"	113	77	250	100	16	455	484	240	19
TV-8" Super-Open 12"	139	87	305	138	16	570	620	300	19

Model	J	K	L	M					Weight(kg)
TV-6" Super-Open 10"	19	160	44	162	250	329	389	468	36
TV-8" Super-Open 12"	24	215	61	230	305	419	469	583	62

Order #	Price Each
438-TV-6	\$649.00
438-TV-8	\$1,299.00

GH-6 & GH-8 Vises

Versatile machine vise which can be mounted on its end, side or base.

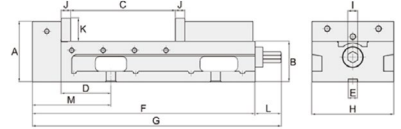

SPECIFICATIONS (Material: FCD 55 Ductile Iron. Hardness: HRC 50°)

Unit: mm/inch

Model	A	B	C	D	E	F	G	H	I	J	K	L	M	Weight(kg)
GH-6" Super-Open 8"	115	77	205	95	18	425	475	156	19	18	44	50	150	30
GH-8" Super-Open 12"	148	88	300	100	18	560	610	202	19	18	63	50	175	60

Model							
GH-6" Super-Open 8"	205	8 1/5	273	11 3/25	343	13 18/25	416
GH-8" Super-Open 12"	300	12	393	15 18/25	462	18 12/25	555

Order #	Price Each
438-GH-6	\$599.00
438-GH-8	\$1,199.00

Product	Part No.	Specification	Finish	Colour	STD PKG	PRICE
<p>★★★ PREMIUM 6 X 9 SCM Hand Pads</p>	120769	Aluminum Oxide Coarse	Matte	Tan	10	\$2.69
	120770	Aluminum Oxide Medium	Matte	Maroon	10	\$1.25
	120772	Aluminum Oxide Fine	Matte	Maroon	10	\$1.25
	120774	Aluminum Oxide Very Fine	Matte	Maroon	10	\$1.25
	34248326	Aluminum Oxide Very Fine - Bulk Pack	Matte	Maroon	250	\$0.84
	120781	Aluminum Oxide General Purpose	Matte	Green	10	\$1.17
	120787	Aluminum Oxide Polish	Matte	White	10	\$1.17
	120777	Silicon Carbide Medium	Bright	Black	10	\$1.25
	120779	Silicon Carbide Ultra Fine	Bright	Grey	10	\$1.29

Chum Power
CHUMPOWER MACHINERY CORP.

Made in

- High clamping force 400-700KGf/cm.
- Suitable for high speed running
- Can hold drills, taps and end mills due to high clamping force
- Includes hex key wrench

HEX KEY DRILL CHUCKS

Order Number	Description	Clamping Range	Price
331-CT40223202A	CAT40XGHK13S-90L	0,3-13MM	\$299
331-CT40224202A	CAT40XGHK16S-95L	1,5-16MM	\$329
331-CT50224202A	CAT50XGHK16S-95L	1,5-16MM	\$349
331-HK22526	HSK63AXGHK13S-105	0,3-13MM	\$369
331-HK22528	HSK63AXGHK16S-110	1,5-16MM	\$389
331-BT22518	BT40XGHK13S-98L	0,3-13MM	\$299

SLOKY

Save money by not having to replace screws damaged by over-tightening!

Order #	Togo Kit Includes	Price
309-TPK01-TGTX-12K	Torx Bits T6, T7, T8, T9, T10 and T15 in 25mm and 50mm lengths, 6 Torque Adapters and 2 Handles in a set	\$263.44
309-TPK02-TGIP-12K	Torx Plus Bits 6IP, 7IP, 8IP, 9IP, 10IP and 15IP in 25mm and 50mm lengths, 6 Torque Adapters and 2 Handles in a set	\$283.15
309-TPK03-TGHX-12K	Hex Bits 1.5mm, 2mm, 2.5mm, 3mm, 4mm and 5mm in 25mm and 50mm lengths, 6 Torque Adapters and 2 Handles in a set	\$263.44

NEW Catalogue Available now

METRIC Carbide Screw-on Shanks - Straight

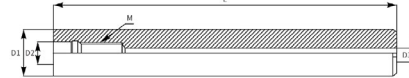

PRISM

EDP Number	Description	Thread	Length	Shank	Price
317-500-107	CSS10-M06-75	M6	75mm	10mm	\$136.13
317-500-108	CSS10-M06-100	M6	100mm	10mm	\$130.50
317-500-109	CSS10-M06-125	M6	125mm	10mm	\$169.89
317-500-110	CSS10-M06-150	M6	150mm	10mm	\$163.12
317-500-111	CSS12-M06-75	M6	75mm	12mm	\$138.38
317-500-112	CSS12-M06-100	M6	100mm	12mm	\$132.73
317-500-113	CSS12-M06-125	M6	125mm	12mm	\$200.25
317-500-114	CSS12-M06-150	M6	150mm	12mm	\$193.51
317-500-115	CSS16-M08-100	M8	100mm	16mm	\$229.50
317-500-116	CSS16-M08-150	M8	150mm	16mm	\$264.38
317-500-117	CSS16-M08-200	M8	200mm	16mm	\$351.01
317-500-118	CSS20-M10-150	M10	150mm	20mm	\$411.73
317-500-119	CSS20-M10-200	M10	200mm	20mm	\$533.26
317-500-120	CSS20-M10-250	M10	250mm	20mm	\$630.01
317-500-121	CSS25-M12-150	M12	150mm	25mm	\$569.25
317-500-122	CSS25-M12-200	M12	200mm	25mm	\$736.86
317-500-123	CSS25-M12-250	M12	250mm	25mm	\$874.13
317-500-124	CSS25-M12-300	M12	300mm	25mm	\$1,041.76
317-500-125	CSS32-M16-200	M16	200mm	32mm	\$1,051.85
317-500-126	CSS32-M16-250	M16	250mm	32mm	\$1,356.75
317-500-127	CSS32-M16-300	M16	300mm	32mm	\$1,600.88
317-500-128	CSS32-M16-350	M16	350mm	32mm	\$2,063.23
317-500-129	CSS32-M16-400	M16	400mm	32mm	\$2,359.13

METRIC Carbide Screw-on Shanks - Necked

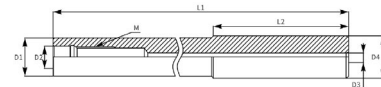

EDP Number	Description	Thread	Length	L2 Length	Shank	Price
317-501-107	CSN10-M06-A25-75	M6	75mm	50mm	10mm	\$152.99
317-501-108	CSN10-M06-A50-100	M6	100mm	50mm	10mm	\$152.99
317-501-109	CSN10-M06-A75-125	M6	125mm	50mm	10mm	\$192.39
317-501-110	CSN10-M06-A100-150	M6	150mm	50mm	10mm	\$192.39
317-501-111	CSN12-M06-A25-75	M6	75mm	50mm	12mm	\$155.24
317-501-112	CSN12-M06-A50-100	M6	100mm	50mm	12mm	\$155.24
317-501-113	CSN12-M06-A75-125	M6	125mm	50mm	12mm	\$221.62
317-501-114	CSN12-M06-A100-150	M6	150mm	50mm	12mm	\$223.87
317-501-115	CSN16-M08-A45-100	M8	100mm	55mm	16mm	\$250.89
317-501-116	CSN16-M08-A95-150	M8	150mm	55mm	16mm	\$294.74
317-501-117	CSN16-M08-A145-200	M8	200mm	55mm	16mm	\$389.23
317-501-118	CSN20-M10-A90-150	M10	150mm	60mm	20mm	\$442.12
317-501-119	CSN20-M10-A140-200	M10	200mm	60mm	20mm	\$578.25
317-501-120	CSN20-M10-A190-250	M10	250mm	60mm	20mm	\$682.88
317-501-121	CSN25-M12-A90-150	M12	150mm	60mm	25mm	\$599.64
317-501-122	CSN25-M12-A140-200	M12	200mm	60mm	25mm	\$781.87
317-501-123	CSN25-M12-A190-250	M12	250mm	60mm	25mm	\$934.86
317-501-124	CSN25-M12-A240-300	M12	300mm	60mm	25mm	\$1,154.25
317-501-125	CSN32-M16-A135-200	M16	200mm	65mm	32mm	\$1,141.88
317-501-126	CSN32-M16-A185-250	M16	250mm	65mm	32mm	\$1,469.24
317-501-127	CSN32-M16-A235-300	M16	300mm	65mm	32mm	\$1,720.13
317-501-128	CSN32-M16-A285-350	M16	350mm	65mm	32mm	\$2,190.36
317-501-129	CSN32-M16-A335-400	M16	400mm	65mm	32mm	\$2,492.98



Winter 2024 Promotions

Celebrating 50 Years in Business

----- 1974-2024 -----



Fractional Carbide Screw-on Shanks - Straight

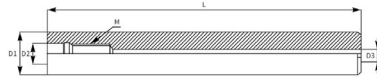

EDP Number	Description	Thread	Length	Shank	Price
336-06204080	ICSS2A06204080	M8	4.00"	0.625"	\$279.00
336-06206080	ICSS2A06206080	M8	6.00"	0.625"	\$389.00
336-07504100	ICSS2A07504100	M10	4.00"	0.750"	\$509.00
336-07506100	ICSS2A07506100	M10	6.00"	0.750"	\$669.00
336-10004120	ICSS2A10004120	M12	4.00"	1.000"	POA
336-10006120	ICSS2A10006120	M12	6.00"	1.000"	POA
336-12506160	ICSS2A12506160	M16	6.00"	1.250"	POA

Screw-on Arbors - BT40 & CAT40 (Arbor-Tapered)

EDP Number	Description	Thread	L1 Length	D1 Ø	D3 Ø	Price
417-BT40M0860	BT40-SO-M08-60 THREADED	M8	60mm	15.4mm	19mm	\$149.00
417-BT40M0890	BT40-SO-M08-90 THREADED	M8	90mm	15.4mm	24mm	\$149.00
417-BT40M08120	BT40-SO-M08-120 THREADED	M8	120mm	15.4mm	30mm	\$179.00
417-CAT40M0890	CAT40-SO-M08-90 THREADED	M8	90mm	15.4mm	30mm	\$149.00
417-CAT40M1090	CAT40-SO-M10-90 THREADED	M10	90mm	19mm	30mm	\$149.00
417-CAT40M10135	CAT40-SO-M10-135 THREADED	M10	135mm	19mm	36mm	\$179.00
417-CAT40M1290	CAT40-SO-M12-90 THREADED	M12	90mm	24mm	29mm	\$149.00
417-CAT40M12135	CAT40-SO-M12-135 THREADED	M12	135mm	24mm	39mm	\$179.00
417-CAT40M1690	CAT40-SO-M16-90 THREADED	M16	90mm	29mm	35mm	\$149.00
417-CAT40M16135	CAT40-SO-M16-135 THREADED	M16	135mm	29mm	41mm	\$179.00

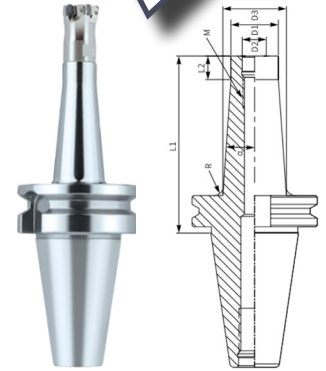

CALIBER Start Up Milling Kit

EDP #	Brand	QTY	Description	Special Package Price
438-GH6	HOMGE	1	Super Open 6"x8" Milling Vice	\$1625.00
117-22227	TECHNIKS	1	CAT40-ER16 Collet Chuck (4" Gage Length)	
117-22253		1	CAT40-ER32 Collet Chuck (2.76" Gage Length)	
117-22917		1	CAT40-1/2" End Mill Holder (3" Gage Length)	
117-22919		1	CAT40-5/8" End Mill Holder (3" Gage Length)	
117-22921		1	CAT40-3/4" End Mill Holder (3.5" Gage Length)	
117-22925-3		1	CAT40-1" End Mill Holder (3" Gage Length)	
117-22711-2.5		1	CAT40-3/4" Shell Mill Adapter (2.5" Gage Length)	
331-CT40223202A	ChumPower	1	CAT40 0.3-13mm Hex Key Drill Chuck	
240-ER16SETIN2	Eurocollet	1	ER16 Collet Set (Inch)	
240-ER32SETIN2		1	ER32 Collet Set (Inch)	



CAT40 ER Collet Chuck



CAT40 Face Mill Arbor



CAT40 End Mill Holder



CAT40 Hex Key Drill Chuck



INCH ER Collet Set

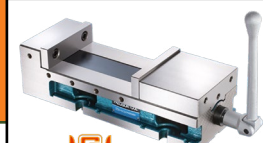

Super Open Milling Vice



Winter 2024 Promotions

Celebrating 50 Years in Business
----- 1974-2024 -----



M213 STREAKERS



M213N STREAKERS

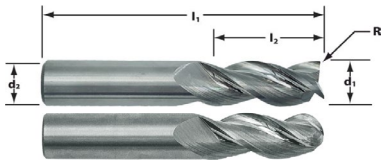

d1: -0.0001 / -0.0004 d2: -0.0001 / -0.0004
cr/ball nose: + / - 0.0015

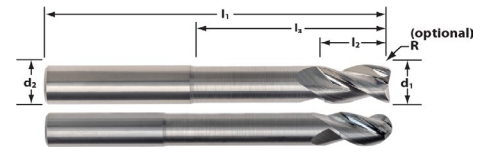

d1: -0.0001 / -0.0004 d2: -0.0001 / -0.0004
cr/ball nose: + / - 0.0015

MAIN BENEFITS

- > 37-degree helix
- > High polish flute face
- > Optimized wiper flat
- > Improved corner strength
- > Extremely large flute cavity
- > Extremely fine cutting edge
- > Uniquely designed end face and gashing
- > For high-performance machining in aluminum alloys.

Cutter Dia d1	Shank Dia d2	Length of Cut L2	Overall Length L1	Order Code SQ	PRICE	.015 CR	.031 CR	PRICE	.062 CR	.093 CR	.125 CR	.187 CR	.250 CR	PRICE	Order Code BN	PRICE
1/8	1/8	3/8	1-1/2	64554	\$18.56	64555	-	\$20.84	-	-	-	-	-	-	64745	\$33.41
		1/2	2	64558	\$26.64	-	-	-	-	-	-	-	-	-	64747	\$34.63
		5/8	2	64559	\$29.11	-	-	-	-	-	-	-	-	-	-	-
		3/4	2	64560	\$39.37	-	-	-	-	-	-	-	-	-	-	-
		1	2	64561	\$39.92	-	-	-	-	-	-	-	-	-	-	-
3/16	3/16	1/2	2	64564	\$27.18	64565	64566	\$28.35	-	-	-	-	-	-	-	-
		5/8	2-1/2	64567	\$27.63	64568	64569	\$28.78	-	-	-	-	-	-	64749	\$36.18
		3/4	2-1/2	64570	\$39.20	-	-	-	-	-	-	-	-	-	-	-
		1	2-1/2	64571	\$43.79	-	-	-	-	-	-	-	-	-	-	-
1/4	1/4	5/8	2-1/2	64579	\$34.59	64580	64581	\$34.88	64582	-	-	-	-	CALL	-	-
		3/4	2-1/2	64583	\$34.68	64584	64585	\$39.04	64586	-	-	-	-	CALL	64751	\$39.60
		1	3	64587	\$36.34	64588	64589	\$44.32	-	-	-	-	-	-	-	-
		1-1/4	3	64590	\$52.60	-	64591	\$57.69	-	-	-	-	-	-	-	-
5/16	5/16	5/8	2-1/2	64595	\$39.02	-	-	-	-	-	-	-	-	-	-	-
		13/16	2-1/2	64596	\$39.41	64597	64598	\$42.53	-	-	-	-	-	-	64752	\$56.15
		1-1/4	3	64600	\$58.06	-	-	-	-	-	-	-	-	-	-	-
3/8	3/8	5/8	2-1/2	64608	\$42.16	64609	64610	\$46.79	64765	64767	-	-	-	CALL	64753	\$60.95
		1	2-1/2	64612	\$44.47	64613	64614	\$49.10	64615	64768	-	-	-	CALL	64754	\$64.54
		1-1/4	3	64616	\$46.98	64617	64618	\$51.61	64619	64769	64620	-	-	CALL	64760	\$85.66
		1-1/2	3-1/2	64621	\$61.53	-	64622	\$65.00	64623	64770	-	-	-	CALL	64761	\$119.56
1/2	1/2	5/8	3	64630	\$64.21	64631	64632	\$68.42	64633	64634	64635	-	-	CALL	64755	\$97.75
		1	3	64637	\$66.68	64638	64639	\$70.35	64640	64641	64642	-	-	CALL	64756	\$98.60
		1-1/4	3	64643	\$70.29	64644	64645	\$73.94	64646	64647	64648	-	-	CALL	64757	\$99.68
		1-5/8	4	64649	\$90.99	64650	64651	\$92.80	64652	64653	64654	-	-	CALL	-	-
		2	4	64655	\$106.52	64656	64657	\$122.19	64658	64659	64660	-	-	CALL	-	-
		2-1/2	5	64662	\$133.33	-	64663	\$148.97	64766	64771	64772	-	-	CALL	64762	\$168.25
5/8	5/8	1-1/4	3-1/2	64670	\$127.53	-	64671	\$143.41	-	-	64672	-	-	CALL	-	-
		1-5/8	4	64673	\$152.15	64674	64675	\$171.25	-	-	64676	-	-	CALL	64758	\$199.40
		2-1/2	5	64681	\$201.14	-	64682	\$219.00	-	-	-	-	-	-	-	-
3/4	3/4	1	4	64684	\$174.35	-	64685	\$192.65	64686	64687	64688	64689	64690	CALL	-	-
		1-5/8	4	64691	\$193.68	-	64692	\$214.57	64693	64694	64695	64696	64697	CALL	64759	\$287.37
		2-1/4	5	64700	\$257.31	-	64701	\$275.56	64702	64703	64704	-	64705	CALL	-	-
		2-1/2	5	64706	\$266.22	-	64707	\$292.86	64708	-	64709	64710	64711	CALL	-	-
1	1	1-1/2	4	64721	\$324.42	-	64722	\$353.51	64723	64724	64725	-	64726	CALL	-	-
		2-1/2	5	64728	\$385.92	-	64729	\$405.86	64730	64731	64732	-	64733	CALL	-	-
		3-1/2	6	64734	\$427.28	-	64735	\$454.37	64736	64737	64738	-	64739	CALL	-	-

Cutter Dia d1	Shank Dia d2	Length of Cut l2	Reach LBS l3	Overall Length l1	Order Code SQ	PRICE	.015 CR	.031 CR	PRICE	.062 CR	.093 CR	.125 CR	.187 CR	.250 CR	PRICE	Order Code BN	PRICE
1/8	1/8	3/16	1	3	64775	\$55.86	64808	-	\$62.03	-	-	-	-	-	-	64907	\$64.41
3/16	3/16	1/4	1	3	64778	\$58.21	64811	64827	\$63.64	-	-	-	-	-	-	64910	\$73.56
1/4	1/4	3/8	1-3/8	3	64780	\$47.97	64813	64829	\$53.88	-	-	-	-	-	-	64912	\$64.41
			1-5/8	3	64781	\$50.23	64814	64830	\$56.13	64856	-	-	-	-	CALL	64913	\$66.64
			2-1/4	4	64782	\$58.60	64815	64831	\$64.53	-	-	-	-	-	-	64914	\$75.05
3/8	3/8	5/8	1-1/8	2-1/2	64783	\$53.97	64816	64832	\$60.95	64857	64874	-	-	-	CALL	64915	\$85.43
			1-1/4	3	64784	\$58.25	64817	64833	\$65.22	64858	-	-	-	-	CALL	64916	\$89.68
			1-5/8	3	64785	\$62.28	64818	64834	\$69.23	64859	-	-	-	-	CALL	64917	\$93.69
			2-1/2	5	64787	\$79.15	-	64836	\$86.13	64860	-	-	-	-	CALL	64919	\$110.58
1/2	1/2	5/8	1-3/8	3	64789	\$85.06	64821	64838	\$93.35	64861	64875	64881	-	-	CALL	64921	\$122.30
			2-1/4	4	64791	\$107.30	64822	64840	\$115.53	64863	64876	64883	-	-	CALL	64923	\$144.50
		3/4	3-1/4	5	64793	\$125.73	64823	64842	\$134.00	64865	-	64885	-	-	CALL	64925	\$162.93
5/8	5/8	3/4	1-3/4	4	64796	\$172.50	-	64845	\$181.62	-	-	64887	-	-	CALL	64928	\$219.75
			2-3/8	5	64797	\$199.91	-	64846	\$209.02	64867	64878	64888	-	-	CALL	64929	\$247.17
3/4	3/4	1	1-3/4	4	64799	\$263.39	-	64848	\$273.31	64868	64879	64890	64897	64899	CALL	64931	\$320.68
			2-3/8	5	64800	\$298.81	-	64849	\$308.73	64869	-	64891	-	-	CALL	64932	\$356.09
			3-3/8	6	64801	\$342.71	-	64850	\$352.66	64870	64880	64892	64898	64900	CALL	64933	\$400.03
1	1	1-1/4	2-5/8	5	64803	\$474.15	-	64852	\$487.38	64872	-	64894	-	64902	CALL	64935	\$542.63
			3-3/8	6	64804	\$510.39	-	64853	\$523.62	-	-	64895	-	64903	CALL	64936	\$578.92



Canadian made variable pitch end mills with enhanced geometries and coating technologies for superior performance in a variety of steels, stainless steels and hardened steels.

Caliber EDP#	HP4 Series	Ø	Shank Ø	LOC	OAL	Radius	# of Flutes	Shank Style	Price
162-25007525-HP		1/4"	1/4"	3/4"	2-1/2"	SQ	4	Cylindrical	\$20.38
162-25007525-015-HP		1/4"	1/4"	3/4"	2-1/2"	0.015"	4	Cylindrical	\$21.02
162-31281225-HP		5/16"	5/16"	13/16"	2-1/2"	SQ	4	Cylindrical	\$21.81
162-31281225-015-HP		5/16"	5/16"	13/16"	2-1/2"	0.015"	4	Cylindrical	\$22.31
162-37587525-HP		3/8"	3/8"	7/8"	2-1/2"	SQ	4	Cylindrical	\$24.38
162-37587525W-HP		3/8"	3/8"	7/8"	2-1/2"	SQ	4	Weldon	\$28.46
162-37587525-015-HP		3/8"	3/8"	7/8"	2-1/2"	0.015"	4	Cylindrical	\$26.46
162-37587525W-015-HP		3/8"	3/8"	7/8"	2-1/2"	0.015"	4	Weldon	\$29.89
162-50010030-HP		1/2"	1/2"	1"	3"	SQ	4	Cylindrical	\$46.69
162-50010030W-HP		1/2"	1/2"	1"	3"	SQ	4	Weldon	\$50.26
162-50010030-030-HP		1/2"	1/2"	1"	3"	0.030"	4	Cylindrical	\$43.40
162-50010030W-030-HP		1/2"	1/2"	1"	3"	0.030"	4	Weldon	\$47.69
162-50012530-HP		1/2"	1/2"	1-1/4"	3"	SQ	4	Cylindrical	\$47.98
162-50012530-030-HP		1/2"	1/2"	1-1/4"	3"	0.030"	4	Cylindrical	\$49.84
162-50012530W-HP		1/2"	1/2"	1-1/4"	3"	SQ	4	Weldon	\$52.27
162-50012530W-030-HP		1/2"	1/2"	1-1/4"	3"	0.030"	4	Weldon	\$53.98
162-62512535-HP		5/8"	5/8"	1-1/4"	3-1/2"	SQ	4	Cylindrical	\$74.29
162-62512535-030-HP		5/8"	5/8"	1-1/4"	3-1/2"	0.030"	4	Cylindrical	\$75.65
162-62512535W-HP		5/8"	5/8"	1-1/4"	3-1/2"	SQ	4	Weldon	\$79.29
162-62512535W-030-HP		5/8"	5/8"	1-1/4"	3-1/2"	0.030"	4	Weldon	\$81.37
162-75015040-HP		3/4"	3/4"	1-1/2"	4"	SQ	4	Cylindrical	\$114.04
162-75015040W-HP		3/4"	3/4"	1-1/2"	4"	SQ	4	Weldon	\$119.76
162-75015040-030-HP		3/4"	3/4"	1-1/2"	4"	0.030"	4	Cylindrical	\$127.34
162-75015040W-030-HP		3/4"	3/4"	1-1/2"	4"	0.030"	4	Weldon	\$133.06



Winter 2024 Promotions

Celebrating 50 Years in Business
----- 1974-2024 -----



Eco Run 90°

90° MILLING KITS



Caliber EDP#	Diameter (D)	Description	Shank Diameter (dm)	# of Inserts	OAL (L)	Neck Length (L1)	Coolant Through	Kit Price
340-709103	5/8"	EM90-D0625-W0750-11-2	3/4"	2	3.50"	1.47"	Yes	\$216.52
c/w 10pcs 340-705915 APMT113508PDER-M PM30P Inserts								
340-709104	3/4"	EM90-D0750-W0750-11-2	3/4"	2	3.50"	1.47"	Yes	\$248.18
c/w 10pcs 340-705915 APMT113508PDER-M PM30P Inserts								
340-709102	1"	EM90-D1000-W1000-11-3	1"	3	4.30"	2.02"	Yes	\$307.76
c/w 10pcs 340-705915 APMT113508PDER-M PM30P Inserts								
340-709100	1"	EM90-D1000-W1000-16-2	1"	2	4.30"	2.02"	Yes	\$291.40
c/w 10pcs 340-705461 APMT160408PDER-M PM30P Inserts								
340-709106	1.25"	EM90-D1250-W1000-16-3	1"	3	4.30"	2.02"	Yes	\$350.99
c/w 10pcs 340-705461 APMT160408PDER-M PM30P Inserts								
340-709107	1.50"	EM90-D1500-W1000-16-3	1"	3	4.30"	2.02"	Yes	\$369.61
c/w 10pcs 340-705461 APMT160408PDER-M PM30P Inserts								

Caliber EDP#	Diameter (D)	Description	Bore Diameter (dm)	# of Inserts	Cutter Height (H)	Coolant Through	Kit Price
340-709108	2"	FM90-D2000-0750-11-6	3/4"	6	1.50"	Yes	\$415.76
c/w 10pcs 340-705915 APMT113508PDER-M PM30P Inserts							
340-709109	2"	FM90-D2000-0750-16-5	3/4"	5	1.50"	Yes	\$431.05
c/w 10pcs 340-705461 APMT160408PDER-M PM30P Inserts							
340-709110	3"	FM90-D3000-1000-16-6	1"	6	2.25"	Yes	\$550.22
c/w 10pcs 340-705461 APMT160408PDER-M PM30P Inserts							
340-709112	4"	FM90-D4000-1000-16-7	1"	7	2.25"	Yes	\$710.35
c/w 10pcs 340-705461 APMT160408PDER-M PM30P Inserts							



CXBN High Feed Mill

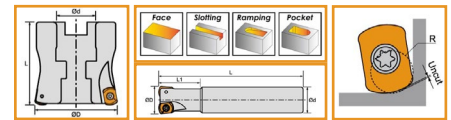

Caliber EDP#	Cutter Ø	Neck Length	OAL	Shank Ø	# of Teeth	Kit Price
336-CXBN602062400	5/8"	1.25"	4"	5/8"	2	\$164.79
C/W 10pcs 336-BNMX0603MGCX32HS Inserts						
336-CXBN603075500	3/4"	1.5"	5"	3/4"	3	\$179.46
C/W 10pcs 336-BNMX0603MGCX32HS Inserts						
336-CXBN604100600	1"	2"	6"	1"	4	\$208.73
C/W 10pcs 336-BNMX0603MGCX32HS Inserts						
336-CXBN607200070	2"	1.57"	3/4"	7		\$275.58
C/W 10pcs 336-BNMX0603MGCX32HS Inserts						



Eco Run HF

HIGH FEED MILLING KITS

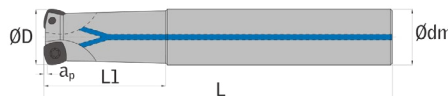

Caliber EDP#	Diameter (D)	Description	Shank Diameter (dm)	# of Inserts	OAL (L)	Neck Length (L1)	Kit Price
340-709012	1.25"	HF12-D1.25-C1.25-12-2	1.25"	2	10"	2.5"	\$370.14
C/W 10pcs 340-705881 SDMT120512-M PM30P Inserts							
340-709013	1.5"	HF12-D1.50-C1.25-12-3	1.25"	3	10"	-	\$407.38
C/W 10pcs 340-705881 SDMT120512-M PM30P Inserts							



Caliber EDP#	Diameter (D)	Description	Bore Diameter (dm)	# of Inserts	Cutter Height (H)	Kit Price
340-709010	2"	HF12-D2.00-0.750-12-4	.750"	4	1.58"	\$444.62
C/W 10pcs 340-705881 SDMT120512-M PM30P Inserts						
340-709014	2.5"	HF12-D2.50-0.750-12-5	.750"	5	1.58"	\$481.86
C/W 10pcs 340-705881 SDMT120512-M PM30P Inserts						
340-709015	3"	HF12-D3.00-1.00-12-6	1.00"	6	1.97"	\$556.34
C/W 10pcs 340-705881 SDMT120512-M PM30P Inserts						
340-709016	4"	HF12-D4.00-1.25-12-8	1.25"	8	1.97"	POA
C/W 10pcs 340-705881 SDMT120512-M PM30P Inserts						
340-709017	5"	HF12-D5.00-1.50-12-10	1.50"	10	2.48"	POA
C/W 10pcs 340-705881 SDMT120512-M PM30P Inserts						

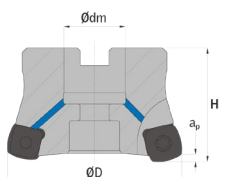



MOLDINO

The Edge To Innovation



STEEL SHANK

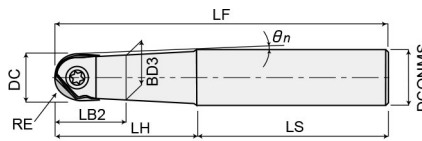

Type A (Taper neck)

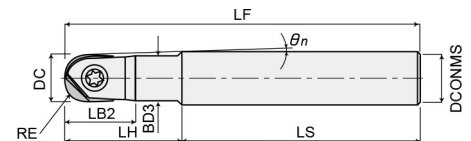

Type B (Straight neck)

REGULAR	Item Code	No. of inserts	Size (inch)									Type	Inserts
			DC	RE	LF	DCONMS	LB2	LH	BD3	LS	Θ_n		
	IABPF05S08	1	.313	.156	3.937	.500	.394	.984	.291	2.953	6.5°	A	IZFG050
	IABPF06S08	1	.375	.188	3.937	.500	.512	.984	.335	2.953	4.5°	A	IZFG060
	IABPF08S08	1	.500	.250	4.331	.500	.591	1.181	.480	3.150	-	B	IZFG080
	IABPF10S10	1	.625	.313	5.118	.625	.748	1.969	.602	3.150	-	B	IZFG100
	IABPF12S12	1	.750	.375	5.512	.750	.866	2.362	.728	3.150	-	B	IZFG120
	IABPF16S16	1	1.000	.500	5.906	1.000	.984	2.756	.980	3.150	-	B	IZFG160

P	Carbon Steels, Tool Steels			
K	Cast Iron, Ductile Cast Iron			
H	Hardened Steels > 50Rc			

General cutting, First recommendation
 General cutting, Second recommendation

High Helix Edge Shape Inserts	Item code	Tolerance Class	TH3 Coating		PN Coating		Size (inch)				
			TH303	PN08M	PN15M	RE	LE	INSL	DC	T	
<p>TYPE SH Hardened</p> <p>TYPE ST Multi-Purpose Up to 53Rc</p> <p>TYPE SC Softer Steels, Stainless</p>	IZPFG050-SH	F	●			0.156	0.217	0.383	0.312	0.083	
	IZPFG060-SH		●			0.188	0.256	0.478	0.375	0.106	
	IZPFG080-SH		●			0.250	0.295	0.574	0.500	0.126	
	IZPFG100-SH		●			0.313	0.315	0.648	0.625	0.165	
	IZPFG120-SH		●			0.375	0.394	0.795	0.750	0.205	
	IZPFG160-SH		●			0.500	0.492	0.943	1.000	0.244	
	IZDFG050-ST	F	★		●	0.156	0.217	0.383	0.312	0.083	
	IZDFG060-ST		★		●	0.188	0.256	0.478	0.375	0.106	
	IZDFG080-ST		★		●	0.250	0.295	0.574	0.500	0.126	
	IZDFG100-ST		★		●	0.313	0.315	0.648	0.625	0.165	
	IZDFG120-ST		★		●	0.375	0.394	0.795	0.750	0.205	
	IZDFG160-ST		★		●	0.500	0.492	0.943	1.000	0.244	
IZDFG050-SC	F			●	0.156	0.217	0.383	0.312	0.083		
IZDFG060-SC				●	0.188	0.256	0.478	0.375	0.106		
IZDFG080-SC				●	0.250	0.295	0.574	0.500	0.126		
IZDFG100-SC				●	0.313	0.315	0.648	0.625	0.165		
IZDFG120-SC				●	0.375	0.394	0.795	0.750	0.205		
IZDFG160-SC				●	0.500	0.492	0.943	1.000	0.244		

Milling Cutter Upgrade (MCU) - ABPF SERIES	KIT EDP No.	KIT Order No.	Cutter Body Part#	Insert Part#	Inserts Qty included in KIT (Pcs)	KIT PRICE
	22935892	KIT-IABPF05S08-1	IABPF05S08	IZPFG050-SH TH303	4	\$180.87
	22935908	KIT-IABPF05S08-2	IABPF05S08	IZDFG050-ST TH303	4	\$180.87
	22935915	KIT-IABPF05S08-3	IABPF05S08	IZDFG050-ST PN15M	4	\$180.87
	22935922	KIT-IABPF05S08-4	IABPF05S08	IZDFG050-SC PN08M	4	\$180.87
	22935939	KIT-IABPF06S08-1	IABPF06S08	IZPFG060-SH TH303	4	\$185.41
	22935946	KIT-IABPF06S08-2	IABPF06S08	IZDFG060-ST TH303	4	\$185.41
	22935953	KIT-IABPF06S08-3	IABPF06S08	IZDFG060-ST PN15M	4	\$185.41
	22935960	KIT-IABPF06S08-4	IABPF06S08	IZDFG060-SC PN08M	4	\$185.41
	22935977	KIT-IABPF08S08-1	IABPF08S08	IZPFG080-SH TH303	4	\$193.16
	22935984	KIT-IABPF08S08-2	IABPF08S08	IZDFG080-ST TH303	4	\$193.16
	22935991	KIT-IABPF08S08-3	IABPF08S08	IZDFG080-ST PN15M	4	\$193.16
	22936004	KIT-IABPF08S08-4	IABPF08S08	IZDFG080-SC PN08M	4	\$193.16
	22936011	KIT-IABPF10S10-1	IABPF10S10	IZPFG100-SH TH303	4	\$240.98
22936028	KIT-IABPF10S10-2	IABPF10S10	IZDFG100-ST TH303	4	\$240.98	
22936035	KIT-IABPF10S10-3	IABPF10S10	IZDFG100-ST PN15M	4	\$240.98	
22936042	KIT-IABPF10S10-4	IABPF10S10	IZDFG100-SC PN08M	4	\$240.98	
22936059	KIT-IABPF12S12-1	IABPF12S12	IZPFG120-SH TH303	4	\$263.89	
22936066	KIT-IABPF12S12-2	IABPF12S12	IZDFG120-ST TH303	4	\$263.89	
22936073	KIT-IABPF12S12-3	IABPF12S12	IZDFG120-ST PN15M	4	\$263.89	
22936080	KIT-IABPF12S12-4	IABPF12S12	IZDFG120-SC PN08M	4	\$263.89	
22936097	KIT-IABPF16S16-1	IABPF16S16	IZPFG160-SH TH303	6	\$421.33	
22936103	KIT-IABPF16S16-2	IABPF16S16	IZDFG160-ST TH303	6	\$421.33	
22936110	KIT-IABPF16S16-3	IABPF16S16	IZDFG160-ST PN15M	6	\$421.33	
22936127	KIT-IABPF16S16-4	IABPF16S16	IZDFG160-SC PN08M	6	\$421.33	



Winter 2024 Promotions

Celebrating 50 Years in Business

----- 1974-2024 -----



82° HIGH-PERFORMANCE COUNTERSINKS - 3-FLAT SHANK

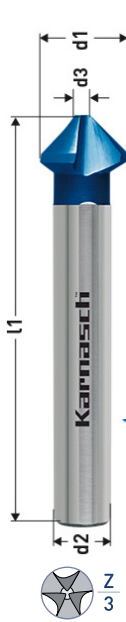

d1 Ø	d3 Ø	L1 Length	d2 Shank	Art. HSS-XE	List	PROMO	Art. HSS-XE + BLUE-TEC	List	PROMO
1/4"	0,059"	1.49/64"	3/16"	20.1780.010	\$30.79	\$18.47	20.1785.010	\$55.13	\$33.08
5/16"	0,078"	1.31/32"	1/4"	20.1780.020	\$32.58	\$19.55	20.1785.020	\$56.74	\$34.04
3/8"	0,087"	1.31/32"	1/4"	20.1780.030	\$34.01	\$20.41	20.1785.030	\$58.35	\$35.01
1/2"	0,11"	2.13/64"	5/16"	20.1780.040	\$40.45	\$24.27	20.1785.040	\$67.48	\$40.49
5/8"	0,126"	2.23/64"	3/8"	20.1780.050	\$51.37	\$30.82	20.1785.050	\$78.40	\$47.04
3/4"	0,138"	2.31/64"	3/8"	20.1780.060	\$58.53	\$35.12	20.1785.060	\$85.56	\$51.34
7/8"	0,15"	2.41/64"	3/8"	20.1780.070	\$73.75	\$44.25	20.1785.070	\$100.78	\$60.47
1"	0,15"	2.41/64"	3/8"	20.1780.080	\$73.75	\$44.25	20.1785.080	\$103.82	\$62.29
1.1/4"	0,165"	2.51/64"	15/32"	20.1780.090	\$104.55	\$62.73	20.1785.090	\$135.34	\$81.20
1.1/2"	0,315"	3.5/32"	15/32"	20.1780.100	\$155.21	\$93.13	20.1785.100	\$233.87	\$140.32

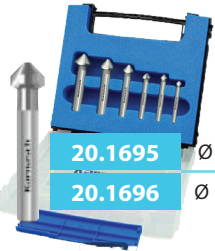

List	Promo
20.1695	Ø 1/4", 5/16", 3/8", 1/2", 5/8", 3/4"
\$268.50	\$161.10
List	Promo
20.1696	Ø 1/4", 3/8", 5/8", 3/4", 1"
\$268.50	\$161.10



List	Promo
20.1697	Ø 1/4", 5/16", 3/8", 1/2", 5/8", 3/4"
\$422.44	\$253.46
List	Promo
20.1698	Ø 1/4", 3/8", 5/8", 3/4", 1"
\$404.54	\$242.72



SSANGYONG CHAMFER MILL

Designed for Large Chamfers and Countersinking

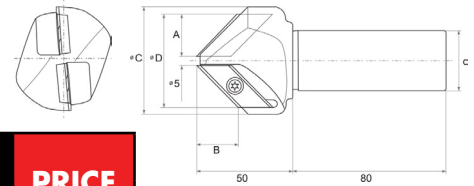

PART NUMBER	DIMENSIONS						NUMBER OF TEETH	PRICE
	INCL. ANGLE	A	B	ØC	ØD	d		
CSC 0503 1R-30-A	60°	0.570"	1.004"	1.574"	1.340"	1.000"	1	\$229.00
CSC 0503 1R-30-A-2F	60°	0.570"	1.004"	1.850"	1.6929"	1.000"	2	\$299.00
CSC 0503 1R-41-A	82°	0.783"	0.859"	2.200"	1.690"	1.000"	2	\$299.00
CSC 0503 1R-45-A	90°	0.826"	0.807"	2.200"	1.850"	1.000"	2	\$299.00
CSC 0503 1R-60-A	120°	1.003"	0.570"	2.830"	2.200"	1.000"	2	\$349.00

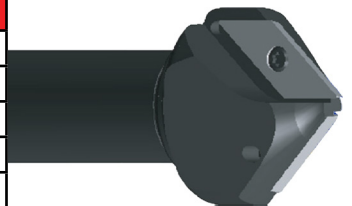

INSERT	DIMENSIONS					GRADE & PRICE		
	l	w	t	D	r	TX520	SCW200	SCW300
XCET 0310404-ER	0.866"	0.500"	0.177"	0.220"	0.016"	\$49.00	\$59.00	\$65.00

TX520 - TiN cermet for finishing applications
SCW200 - Coated carbide grade for heavier duty applications
SXW300 - TiAlN coated carbide for higher speed applications

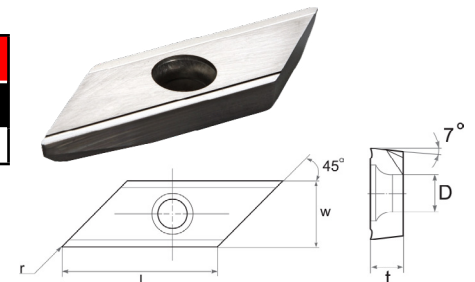

OD		SHK	OAL	SINGLE FLUTE COUNTERSINKS			PRICE
D1	D2	L2	60°	82°	90°		
1/8	1/8	1-1/2	680-002	680-102	680-202	\$12.20	
3/16	3/16	2	680-004	680-104	680-204	\$12.69	
1/4	1/4	2	680-006	680-106	680-206	\$17.64	
3/8	1/4	2-5/8	680-008	680-108	680-208	\$23.42	
1/2	1/4	2-7/8	680-010	680-110	680-210	\$30.62	
5/8	3/8	3	680-012	680-112	680-212	\$47.15	
3/4	1/2	3	680-014	680-114	680-214	\$64.07	
1	1/2	2-3/4	680-016	680-116	680-216	\$123.18	

- Genuine A-Gr-SiV submicron grain carbide
- Proven, versatile performance



****Uncoated****
Standard, Series 680

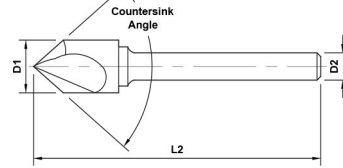

Coated
Available
Upon Request

OD		SHK	OAL	THREE FLUTE COUNTERSINKS				PRICE
D1	D2	L2	60°	82°	90°	100°		
1/8	1/8	1-1/2	680-302	680-402	680-502	-	\$12.20	
3/16	3/16	2	680-304	680-404	680-504	-	\$12.69	
1/4	1/4	2	680-306	680-406	680-506	682-106	\$17.64	
3/8	1/4	2-5/8	680-308	680-408	680-508	682-108	\$23.42	
1/2	1/4	2-7/8	680-310	680-410	680-510	682-110	\$30.62	
5/8	3/8	3	680-312	680-412	680-512	682-112	\$47.15	
3/4	1/2	3	680-314	680-414	680-514	682-114	\$64.07	
1	1/2	2-3/4	680-316	680-416	680-516	682-116	\$123.18	

- Genuine A-Gr-SiV submicron grain carbide
- Proven, versatile performance



****Uncoated****
Standard, Series 680

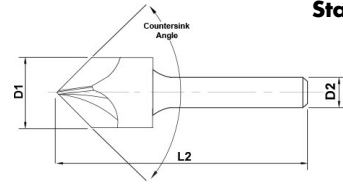

Coated
Available
Upon Request

OD		SHK	OAL	SIX FLUTE COUNTERSINKS				PRICE
D1	D2	L2	60°	82°	90°	100°		
1/8	1/8	1-1/2	680-602	680-702	680-802	-	\$12.20	
3/16	3/16	2	680-604	680-704	680-804	-	\$12.69	
1/4	1/4	2	680-606	680-706	680-806	680-906	\$17.64	
3/8	1/4	2-5/8	680-608	680-708	680-808	680-908	\$23.42	
1/2	1/4	2-7/8	680-610	680-710	680-810	680-910	\$30.62	
5/8	3/8	3	680-612	680-712	680-812	680-912	\$47.15	
3/4	1/2	3	680-614	680-714	680-814	680-914	\$64.07	
1	1/2	2-3/4	680-616	680-716	680-816	680-916	\$123.18	

- Genuine A-Gr-SiV submicron grain carbide
- Proven, versatile performance



****Uncoated****
Standard, Series 680

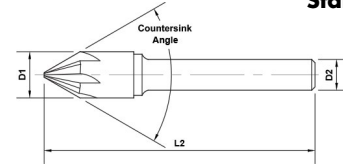

Coated
Available
Upon Request

CHAMFERMILLS WITH WELDON SHANKS (Series CHM)



Inserts sold separately.

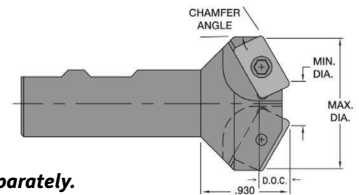

PART NUMBER	DESCRIPTION	MIN DIA	MAX DIA	WELDON SHANK	CHAMFER ANGLE	NUMBER OF FLUTES	DEPTH OF CUT	OVERALL LENGTH	INSERT	PRICE
209-01270	CHM-750-30	0.750	1.303	3/4	30°	2	0.479	3.000	APLT-347	\$171.77
209-01268	CHM-688-41	0.688	1.414	3/4	41°		0.418			\$171.77
209-01269	CHM-688-45	0.688	1.471	3/4	45°		0.391			\$171.77
209-01267	CHM-500-60	0.500	1.458	3/4	60°		0.277			\$171.77



CAT40 ER COLLET CHUCKS

and
Find Out How To SAVE
Up To an Additional 10%!

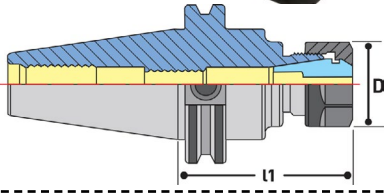

Part #	Description	L1	D	Max. Shank	Stop Screw	Wrench	Nut	PRICE
22225	CAT40 x ER16 - 2.76", hex nut	2.76"	1.08"	.406"	16083	04609	41116	\$91.50
22227	CAT40 x ER16 - 4", hex nut	4"	1.08"	.406"	16083	04609	41116	\$92.50
22253	CAT40 x ER32 - 2.76", slotted nut	2.76"	1.97"	.788"	16089	04616	41932	\$98.50
22255	CAT40 x ER32 - 4", slotted nut	4"	1.97"	.788"	16089	04616	41932	\$98.50



Digital Microscope with LCD Display

- * VGA camera sensor, camera rechargeable
- * Manually adjustable focus via hand wheel
- * 10 - fold zoom function (in 10%-steps)
- * Colour display, 720 pixels
- * Video format AVI, photo format JPG
- * Mini USB connection for charging cables
- * Mini -SD card slot



EDP # 370-521-0347

SALE PRICE: \$135.66

SCAN to View
Specification Table



jokisch® Metal Cutting Paste



ECONO 897 PASTE
8.8 OZ./250 G

ECONO 897 PASTE
26.9 OZ./750 G

ECONO 897 PASTE
11 LBS/5 KG

EDP#166-E89.700.250
PRICE: \$23.58

EDP#166-E89.700.750
PRICE: \$53.89

EDP# 166-E89.700.005
PRICE: \$250.46



Outside Micrometer (INCH)

- * With ratchet friction thimble
- * Carbide measuring face
- * Frame painted, scale chrome finished
- * With adjusting key
- * From size 25-50mm including setting gauge
- * Includes inspection certificate in cardbox



EDP #	Range	Reading	SALE PRICE
370-217-5585	0-1"	0.0001"	\$31.71
370-217-5592	1-2"	0.0001"	\$36.32
370-217-5608	2-3"	0.0001"	\$43.24
370-217-5615	3-4"	0.0001"	\$49.01
370-217-5622	4-5"	0.0001"	\$63.42
370-217-5639	5-6"	0.0001"	\$72.07



DEBURRING TOOL

Handle	Order #	PRICE
Set B	140-29065	\$17.37
Set E	140-29069	\$20.28



10+2 Blades Bonus Pack		
Blade	Order #	PRICE
B10	140-26262	\$13.93
B20	140-29269	\$18.72
E100	140-26270	\$14.62
E200	140-29271	\$18.72
E100P	140-29258	\$33.60



Large Display Dial Caliper

- * Shockproof design
- * Hardened stainless steel
- * Four way measurement
- * Threading table on back
- * Upper set screw & flat depth rod
- * Includes inspection report



EDP #	Range	Reading	SALE PRICE
370-210-8388	0-6"	0.001"	\$59.79
370-210-8883	0-8"	0.001"	\$79.30
370-210-8890	0-12"	0.001"	\$115.89



General Purpose Jobber Length Drill Set

CLE-LINE.

- * Style 1899 High Speed Steel
- * Spiral Flute
- * Steam Oxide Finish
- * 1/16" - 1/2" Size
- * 29 Pieces

Order# 122-C21118

**PRICE
\$91.00**



**Limited
QTY**



Winter 2024 Promotions

Celebrating 50 Years in Business
----- 1974-2024 -----

