

DISTRIBUTED BY



# TOOL A THON



**MARCH 1 – AUGUST 31, 2026**  
**VOLUME 26.1**



**ECLIPSE**  
TOOLS NORTH AMERICA INC

Call: 905.624.5524



Email: [sales@caliberindustrial.com](mailto:sales@caliberindustrial.com)

# Baty Profile Projector Retrofit

## Simple, plug and play

**Improve your optical comparator functionality and accuracy!**

With our retrofit program you can dramatically enhance the functionality of your current optical comparator. Advanced error mapping - increase accuracy of your comparator. Comprehensive reporting including dimensioned drawing, SPC and EXCEL™ compatible first article inspection reports.

Compatible comparator types:

- Baty • Starrett • Mitutoyo • Tesa

Upgrades include:

- 22" touch screen
- Intel NUC mini PC - Windows 10 OS
- Fusion FT2-E metrology software
- Optical edge sensor - remove operator influence
- Fast data point acquisition
- Entire system is plug and play
- Best fitting of profile data to imported DXF files - No Overlays!

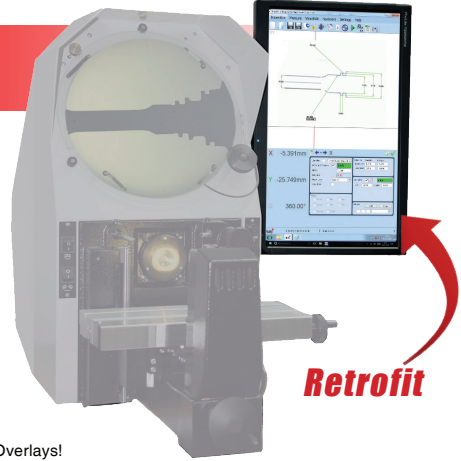

## Retrofit

Part No.	Description
FT2-E-ACE-RETRO-DT	FT2-E including small format PC and scale converter cables for Deltronic scales.
FT2-E-ACE-RETRO-DV	FT2-E including small format PC with Deva connections.
FT2-E-ACE-RETRO-HH	FT2-E including small format PC, scale interpolators and scale converter cables for Heidenhain scales.
FT2-E-ACE-RETRO-MT	FT2-E including small format PC and scale interpolators and scale converter cables for Mitutoyo scales.
FT2-E-ACE-RETRO-QC	FT2-E including small format PC and scale converter cables for Acu-rite MiL scales.
FT2-E-ACE-RETRO-Q9	FT2-E including small format PC and scale converter cables for Acu-rite D9 scales.
FT2-E-ACE-RETRO-RA	FT2-E including small format PC and scale converter cables for Rational scales.
FT2-E-ACE-RETRO-NK	FT2-E including small format PC and scale converter cables for ISKRA RG113 DO scales fitted to NIKON.

**Call the Sales Team at Eclipse Tools NA Inc. for more information! 1-800-260-2124**

## Baty SM350 Profile Projector

**Features:**

- Fully usable 14" (350mm) screen
- Digital screen protractor
- Built in helix adjustment
- Sturdy all-steel design
- Heavy duty cross roller bearings
- Quick release 'X' and 'Y' travel
- Easy-view vertical screen
- Large stage travel 10" (250mm) x 5" (125mm)
- Rotating chart clips
- Fibre optic illumination for surface measurement
- 0.5 micron resolution

Part No. **SM350FT2-E**



# Baty R14 Profile Projector

## Features:

- 14" (340mm) screen with 90° crosslines and chart clips
- Profile illumination with halogen lamp and green filter
- Surface illumination (fibre optic)
- Workstage with machined slot for holding accessories
- Digital angle measurement to 1 minute
- 0.5 micron resolution

Part No. R14FT2-E

baty

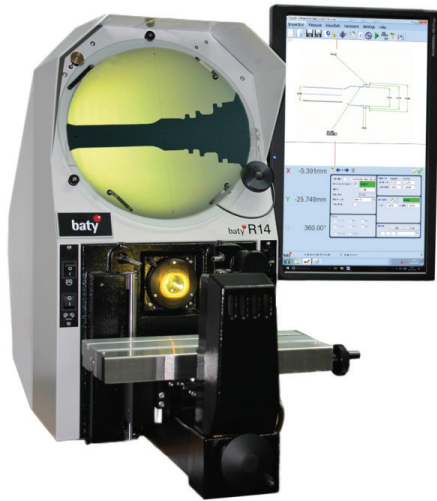

26.1

# Baty R400 Profile Projector

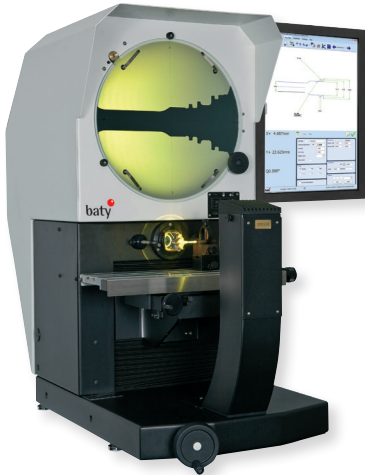

## Features:

- 16" (400mm) screen
- Optical Edge Sensor combined with Baty FUSION software makes for the most functional, user-friendly comparator on the market
- Additional accessories available

Part No. R400FT2-E

Baty

# Baty R600 Profile Projector

## Features:

- 24" (600mm) screen with 90° cross lines and chart clips
- Heavy duty workstage with 18" x 8" (450mm x 200mm) measuring range and 2 machine slots for workpiece holders
- 4 position rotating lens turret for ease of lens changing
- Profile illumination with halogen lamp and green filter
- Screen hood and curtains for use in bright ambient light conditions
- Surface illumination (fibre optic)
- Digital angle measurement
- 0.5 micron resolution

Part No. R600FT2-E

baty



Prices & Specifications are subject to change without notice.

3

TOOLS NORTH AMERICA INC  
**ECLIPSE**

# Baty Venture 3030 CNC XT Multi-Sensor Vision System



#### Features:

- Teach and repeat programming
- 6.5:1 zoom optics (with optional CNC control)
- High resolution 0.5 $\mu$ m scales for increased accuracy
- Auto program from CAD
- Fully dimensioned part view
- SPC included

**baty**

Part No. VI-3030-CNC-XT

*Call the Sales Team at Eclipse Tools NA Inc.  
for more information! 1-800-260-2124*

## Baty Velo FV

Entry Level, Fixed Stage Machine

#### Features:

- Delivers hundreds of measurements per second
- Fully automatic inspection with CNC playback
- 100 x 80mm measuring range
- Motorized Auto-Focus with 75mm travel
- Programmable LED surface ring light
- Telecentric optics for high accuracy
- Automatic measurement, extract features from the scanned part
- Auto program from CAD, features, dimensions and tolerances
- Full reporting and SPC with immediate on screen PASS/FAIL classification
- Simple, easy to use software and user interface
- Character recognition - identify part numbers in a batch

**baty** **Velo**  
FV

- Lower Cost
- Faster ROI
- Greater Flexibility

**NEW!**



Part No. VI-FV1080V

**Promo \$19,995.00**

# Baty Checkmaster 1060

## Features:

- Unique 3 gauge station and readout capability
- Remarkable versatility and repeatability
- Accepts most dial indicators, digital indicators (12.7mm travel) and Gauging Probes
- Multi functional
- Ideal for SPC and 100% inspection
- Left or right hand operation

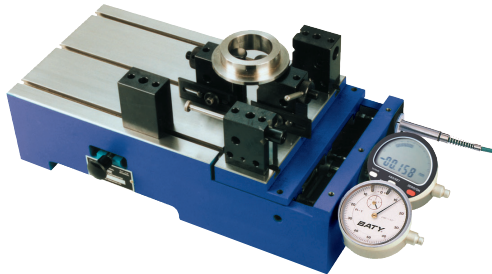

Part No. 1060-Li

Call the Sales Team at Eclipse Tools NA Inc. for more information! 1-800-260-2124

# Bowers XT-Series Holemikes

Vernier Bore Micrometers

## Features:

- 3-pt contact with tungsten carbide measuring anvils above 0.5"
- Blind bore measuring heads featured above 0.5"
- Ratchet stop for consistent measuring
- Extensions available for deep measuring
- Includes UKAS certificates for all Holemikes and setting rings



MXTA10i



SXTA5i



BOWERS GROUP



Made in ENGLAND

Part No.	Range	Grads.	Meas. Accuracy	Ring Depth	Ring Included	List Price	Sale Price
MXTA5i	0.200" - 0.250"	0.00025"	0.00015"	0.70"	0.200"	\$1,442.56	<b>\$1,298.30</b>
MXTA6i	0.250" - 0.312"	0.00025"	0.00015"	2.28"	0.312"	\$693.99	<b>\$624.59</b>
MXTA8i	0.312" - 0.375"	0.00025"	0.00015"	2.28"	0.312"	\$644.97	<b>\$580.47</b>
MXTA10i	0.375" - 0.500"	0.00025"	0.00015"	2.28"	0.500"	\$644.97	<b>\$580.47</b>
MXTA12i	0.500" - 0.625"	0.00025"	0.00015"	2.44"	0.500"	\$644.97	<b>\$580.47</b>
MXTA16i	0.625" - 0.750"	0.00025"	0.00015"	2.44"	0.750"	\$650.55	<b>\$585.50</b>
Sets							
SMXTA1i	0.080" - 0.120"	2 heads, 2 handles, 1 ring				\$2,940.82	<b>\$2,646.74</b>
SMXTA2i	0.120" - 0.250"	2 heads, 2 handles, 1 ring				\$3,985.70	<b>\$3,587.13</b>
SMXTA3i	0.250" - 0.375"	2 heads, 2 handles, 1 ring				\$1,160.73	<b>\$1,044.66</b>
SMXTA4i	0.375" - 0.750"	3 heads, 3 handles, 2 rings				\$1,737.75	<b>\$1,563.98</b>

Prices & Specifications are subject to change without notice.

## Bowers XTH3 Digital Bore Gauge Sets With Bluetooth

### Features:

- Coolant proof, dust proof - IP67
- Resolution: 0.00005"/0.001mm
- Bluetooth connectivity to your phone or tablet
- Self centering 3 point heads above 0.250"
- Tungsten carbide measuring faces on all 3-point heads from 0.500"/12.5mm and up
- Sizes over 0.500"/12.5mm feature blind bore capability



BOWERS GROUP



SXTH6i-BT

For special application heads, contact the Eclipse Sales Team 1-800-260-2124

Part No.	Range	Includes	List Price	Sale Price
Pistol Grip Complete Sets				
SXTH1i-BT	0.080" - 0.250"/2 - 6mm (2 pt.)	5 heads, 1 handle, 3 rings	\$8,038.22	<del>\$7,234.40</del>
SXTH3i-BT	0.250" - 0.375"/6 - 10mm	2 heads, 1 handle, 1 ring	\$3,064.47	<del>\$2,758.02</del>
SXTH4i-BT	0.375" - 0.750"/10 - 20mm	3 heads, 1 handle, 2 rings	\$3,616.98	<del>\$3,255.28</del>
SXTH5i-BT	0.750" - 2"/20 - 50mm	3 heads, 1 handle, 2 rings	\$4,660.75	<del>\$4,194.68</del>
SXTH6i-BT	2" - 4"/50 - 100mm	3 heads, 1 handle, 2 rings	\$5,213.26	<del>\$4,691.93</del>
SXTH7i-BT	4" - 6"/100 - 150mm	2 heads, 1 handle, 1 ring	\$4,660.75	<del>\$4,194.68</del>
SXTH8i-BT	6" - 8"/150 - 200mm	2 heads, 1 handle, 1 ring	\$6,257.03	<del>\$5,631.33</del>
SXTH9i-BT	4" - 8"/100 - 200mm	4 heads, 1 handle, 2 rings	\$10,003.22	<del>\$9,002.90</del>
SXTH11i-BT	0.750" - 4"/20 - 100mm	6 heads, 1 handle, 4 rings	\$7,792.05	<del>\$7,012.85</del>
SXTH10i-BT	0.250" - 0.750"/6 - 20mm	5 heads, 1 handle, 3 rings	\$4,292.03	<del>\$3,862.83</del>
Connectivity Cables/Accessory				
926.6721.10	Proximity cable with USB connection		\$257.15	<del>\$244.29</del>
926.6723	Proximity cable with serial connection		\$255.63	<del>\$242.85</del>
981.7100	USB bluetooth receiver		\$173.24	<del>\$164.58</del>

## Bowers XTD3 Digital Bore Gauge Sets With Bluetooth

### Features:

- Coolant proof, dust proof - IP67
- Resolution: 0.00005"/0.001mm
- Bluetooth connectivity to your phone or tablet
- Self centering 3 point heads above 0.250"
- Tungsten carbide measuring faces on all 3-point heads from 0.500"/12.5mm and up
- Sizes over 0.500"/12.5mm feature blind bore capability



BOWERS GROUP



SXTD3i-BT

Part No.	Range	Includes	List Price	Sale Price
Holemike Complete Sets (Traditional style)				
SXTD1i-BT	0.080" - 0.250"/2 - 6mm (2 pt.)	5 heads, 1 handle, 3 rings	\$7,362.06	<del>\$6,625.85</del>
SXTD3i-BT	0.250" - 0.375"/6 - 10mm	2 heads, 1 handle, 1 ring	\$2,940.82	<del>\$2,646.74</del>
SXTD4i-BT	0.375" - 0.750"/10 - 20mm	3 heads, 1 handle, 2 rings	\$3,555.71	<del>\$3,200.14</del>
SXTD5i-BT	0.750" - 2"/20 - 50mm	3 heads, 1 handle, 2 rings	\$4,905.81	<del>\$4,415.23</del>
SXTD6i-BT	2" - 4"/50 - 100mm	3 heads, 1 handle, 2 rings	\$5,397.06	<del>\$4,857.35</del>
SXTD7i-BT	4" - 6"/100 - 150mm	2 heads, 1 handle, 1 ring	\$4,538.22	<del>\$4,084.40</del>
SXTD8i-BT	6" - 8"/150 - 200mm	2 heads, 1 handle, 1 ring	\$6,073.23	<del>\$5,465.91</del>
SXTD9i-BT	4" - 8"/100 - 200mm	4 heads, 1 handle, 2 rings	\$9,695.77	<del>\$8,726.19</del>
Connectivity Cables/Accessory				
926.6721.10	Proximity cable with USB connection		\$257.15	<del>\$244.29</del>
926.6723	Proximity cable with serial connection		\$255.63	<del>\$242.85</del>

# Bowers XTD3 Digital Bore Gauge Sets with Bluetooth (With Digital Readout for Each Head)

## Features:

- Coolant proof, dust proof - IP67
- Resolution: 0.00005"/0.001mm
- Bluetooth connectivity to your phone or tablet
- 4 preset memories
- Tungsten carbide measuring faces on all 3-point heads from 0.500"/12.5mm and up
- Sizes over 0.500"/12.5mm feature blind bore capability



SXTD6U-BT



BOWERS GROUP



MADE IN ENGLAND

Protected to  
IP67  
DUST & LIQUID  
RESISTANT

Part No.	Range	Includes	List Price	Sale Price
SXTD3U-BT	6 - 10mm	2 heads, 1 ring, 2 display units	\$4,580.54	<del>\$4,122.49</del>
SXTD4U-BT	10 - 20mm	3 heads, 2 rings, 3 display units	\$6,994.46	<del>\$6,295.01</del>
SXTD5U-BT	20 - 50mm	3 heads, 2 rings, 3 display units	\$8,713.28	<del>\$7,841.95</del>
SXTD6U-BT	50 - 100mm	3 heads, 2 rings, 3 display units	\$9,573.24	<del>\$8,615.92</del>

## Bowers Bore Gauge Extensions

Bowers XT Bore gauge extensions allow you to screw the display unit in one end and head unit at the other to increase the measuring depth of your gauge.

## Features:

- Extensions are interchangeable between the XT models e.g. XTA, XTD and XTH



BOWERS GROUP



MADE IN ENGLAND



EGX0200

Part No.	Length	To Fit Heads	List Price	Sale Price
EGX0200	2.5"/63mm	0.125" - 0.375"/6 - 10mm	\$202.73	<del>\$182.46</del>
EGX0400	3.0"/76mm	0.375" - 0.500"/10 - 12.5mm	\$202.73	<del>\$182.46</del>
EGX0500	4.0"/100mm	0.500" - 0.750"/12.5 - 20mm	\$202.73	<del>\$182.46</del>
EGX0001	6.0"/150mm	0.750" - 2"/20 - 50mm	\$300.76	<del>\$270.68</del>
EGX0004	6.0"/150mm	2" - 12"/50 - 300mm	\$319.70	<del>\$287.73</del>



## Bowers Application Measuring Heads Available Upon Request

- ✓ Grooves
- ✓ Threads
- ✓ Splines
- ✓ Spherical

and more!

1-800-260-2124

# Bowers Ultima Bore Gauging System

World's most accurate system!

## Features:

- Accuracies of 0.00004" up to 1.97"
- Ceramic anvils with blind bore capabilities above 0.472"
- Uses compact, multi function Sylvac display



D62S



Display not included



BOWERS GROUP



MADE IN ENGLAND

Part No.	Description	Set Includes	List Price	Sale Price
USET2DW	0.078" - 0.236"/2 - 6mm	Includes: handle, rings & heads	\$7,618.70	<b>\$6,856.83</b>
USET3DW	0.236" - 0.393"/6 - 10mm	Includes: handle, rings & heads	\$4,526.93	<b>\$4,074.24</b>
USET4DW	0.393" - 0.787"/10 - 20mm	Includes: handle, rings & heads	\$5,808.77	<b>\$5,227.90</b>
USET7DW	0.236" - 0.787"/6 - 20mm	Includes: handle, rings & heads	\$6,794.09	<b>\$6,114.68</b>
USET8DW	0.787" - 1.970"/20 - 50mm	Includes: handle, rings & heads	\$8,477.69	<b>\$7,629.92</b>
USET9DW	1.970" - 3.940"/50 - 100mm	Includes: handle, rings & heads	\$9,724.29	<b>\$8,751.86</b>
USET10DW	0.787" - 3.940"/20 - 100mm	Includes: handle, rings & heads	\$14,946.39	<b>\$13,451.75</b>
Digital Displays				
804.1062	Sylvac D62S Digital Display		\$2,360.60	<b>\$2,242.57</b>
804.1063.10	Sylvac D62S Advanced Digital Display		\$3,428.95	<b>\$3,257.50</b>

## Bowers Digital Lever Bore Gauge Sets

### Features:

- Excellent for vertical bore measurement
- Resolution: 0.00005"/0.001mm
- Bluetooth connectivity to your phone or tablet
- 2 preset memories
- Tungsten carbide measuring faces on all 3-point heads from 0.500"/12.5mm and up
- Sizes over 0.500"/12.5mm feature blind bore capability



SXTL3i-BT



BOWERS GROUP



MADE IN ENGLAND



Part No.	Range	Description	List Price	Sale Price
SXTL3i-BT	0.250" - 0.375"/6 - 10mm	Mini Indicator	\$2,940.82	<b>\$2,646.74</b>
SXTL4i-BT	0.375" - 0.750"/10 - 20mm	Mini Indicator	\$3,494.44	<b>\$3,145.00</b>
SXTL5i-BT	0.750" - 2"/20 - 50mm	Mini Indicator	\$4,783.28	<b>\$4,304.95</b>
SXTL6i-BT	2" - 4"/50 - 100mm	Mini Indicator	\$5,520.71	<b>\$4,968.64</b>

# Moore & Wright Surface Roughness Tester

## Features:

- Bright LCD display for wide angle viewing
- Digital signal processing for high accuracy measurement
- Selectable measuring parameters, sample distance and units
- Internal storage of 500 data points
- Data export to PC, analysis and reporting by dedicated software
- Aluminum housing for high durability and protection from electromagnetic interference



Part No. MWT-1100

**Sale \$1,871.<sup>10</sup>**

List Price \$2,079.00

# Moore & Wright Coating Thickness Gauge Ferrous

## Features:

- Graphic LCD with backlight
- Compact size with integrated probe.
- Magnetic induction method (ISO 2178, ASTM D7091, ASTM B499), measurement of non-magnetic coatings on magnetic substrates
- Data memory up to 500 readings
- Ready to measure immediately without calibration
- Easy-to-perform zero-point correction



Part No. MWT-2100

**Sale \$739.<sup>60</sup>**

List Price \$821.88

# Moore & Wright Digital Ultrasonic Thickness Gauge

## Features:

- Use of ultrasound to determine material thickness
- High accuracy measurement over a wide range
- Three measuring modes, P-E, I-E, Test
- IE mode can pass through 500 µm coating
- Accuracy (mm) =  $H < 10 \pm 0.05$ ,  $H \geq 10 \pm 0.04 + 0.5\%H$
- Suitable for measuring steel, iron, glass, plastic, aluminium, etc
- Fully configurable test parameters
- Metric or imperial, selectable resolution of 0.1 or 0.01mm



Part No. MWT-2500

**Sale \$998.<sup>99</sup>**

List Price \$1,123.29

## Moore & Wright Leeb Hardness Tester

### Features:

- Can be used on steel and cast steel, alloy tool steel, grey cast iron, ductile iron, cast aluminum alloy, copper zinc alloy (brass), copper tin alloy (bronze), pure copper
- Equivalent values from 6 additional hardness standards displayed simultaneously on screen
- Colour screen LCD with adjustable brightness
- Leeb hardness shock wave display for additional diagnostics
- Compact & portable
- Suitable for harsh operating environments



Part No. MWT-3100

**Sale \$1,519.<sup>15</sup>**

List Price \$1,687.94



## Moore & Wright Carbon Fibre Caliper

### Features:

- Reinforced carbon fibre for reduced weight and ease of use
- Extended length caliper options for the measurement of large objects up to 1.5 meters
- Large backlit colour LCD display
- Selectable as metric or imperial display, both scales etched on beam
- IP65 ingress protection



Part No.	Range	Resolution	Jaws	List Price	Sale Price
MW153-60DDL	0-24"	0.0005"	138mm	\$1,108.80	<b>\$997.92</b>
MW153-75DDL	0-40"	0.0005"	138mm	\$1,501.93	<b>\$1,351.74</b>
MW153-80DDL	0-60"	0.0005"	150mm	\$2,259.65	<b>\$2,033.69</b>

## Moore & Wright Digital Dial Caliper

### Features:

- Large backlit colour LCD display within a metal housing
- Measurement can be displayed as a dial, as digits, or both combine
- Configuration menu including multiple brightness and time off settings
- Built in wireless data transfer for data export direct to a Windows application (Excel, Word, Notepad)
- Tolerance settings with Go / No Go indication via green / red numeric display
- IP67 ingress protection
- Supplied in a protective case
- Range: 0-6"
- Resolution: 0.0005"
- Accuracy: 0.001"
- Jaws: 40mm length

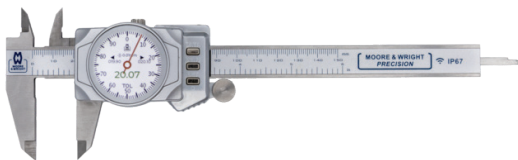

Part No. MW148-15D

**Sale \$279.<sup>98</sup>**

List Price \$298.58



# Moore & Wright Dial Calipers

**Features:**

- Standard: DIN 862
- High-quality shockproof dial caliper
- Hardened stainless steel rack

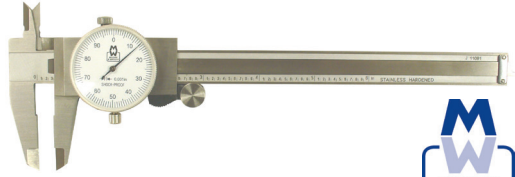

Part No.	Range	Resolution	List Price	Sale Price
MW143-15I	0-6"/0-150mm	0.001"/0.03mm	\$91.98	<b>\$31.39</b>
MW143-20I	0-8"/0-200mm	0.001"/0.03mm	\$112.42	<b>\$38.43</b>

# Moore & Wright Digital Caliper

**Features:**

- Functions: mm/inch conversion, on/off, zero-setting, ABS/INC, Auto off
- 4-way measurement
- All metal parts made of hardened steel

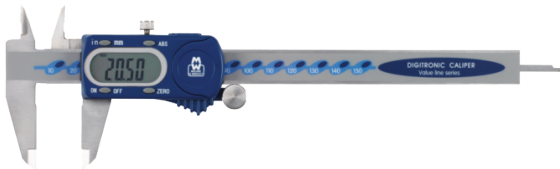

Part No.	Range	Resolution	Jaws	List Price	Sale Price
MW110-15DBL	0-6"	0.0005"	40mm	\$140.83	<b>\$126.75</b>
MW110-20DBL	0-8"	0.0005"	50mm	\$185.90	<b>\$167.31</b>
MW110-30DBL	0-12"	0.0005"	60mm	\$271.17	<b>\$244.05</b>

# Moore & Wright Digital Height Gauge

**Features:**

- Easy to read LCD display
- Fine adjustment for high precision measurement
- Supplied with carbide tipped scriber



Part No.	Range	Resolution	List Price	Sale Price
MW193-30DDL	0-12"/0-300mm	0.0005"/0.01mm	\$1,039.22	<b>\$935.30</b>
MW193-60DDL	0-24"/0-600mm	0.0005"/0.01mm	\$1,436.73	<b>\$1,293.06</b>

# Moore & Wright Digital External Micrometer

## Features:

- 2 Button design
- IP65
- SPC Data output
- Resolution = 0.00005" / 0.001mm
- Carbide measuring faces
- mm/inch conversion
- Range up to 12" / 300mm



MW203-02DABI



Part No.	Range	Resolution	List Price	Sale Price
MW203-01DABI	0" - 1" / 0 - 25mm	0.00005" / 0.001mm	\$311.05	<del>\$279.94</del>
MW203-02DABI	1" - 2" / 25 - 50mm	0.00005" / 0.001mm	\$349.50	<del>\$314.55</del>
MW203-03DABI	2" - 3" / 50 - 75mm	0.00005" / 0.001mm	\$405.96	<del>\$365.36</del>
MW203-04DABI	3" - 4" / 75 - 100mm	0.00005" / 0.001mm	\$454.98	<del>\$409.48</del>
MW203-05DABI	4" - 5" / 100 - 125mm	0.00005" / 0.001mm	\$503.22	<del>\$452.90</del>
MW203-06DABI	5" - 6" / 125 - 150mm	0.00005" / 0.001mm	\$556.62	<del>\$509.96</del>
MW203-07DABI	6" - 7" / 150 - 175mm	0.00005" / 0.001mm	\$609.56	<del>\$548.61</del>
MW203-08DABI	7" - 8" / 175 - 200mm	0.00005" / 0.001mm	\$686.62	<del>\$617.96</del>
MW203-09DABI	8" - 9" / 200 - 225mm	0.00005" / 0.001mm	\$721.23	<del>\$649.11</del>
MW203-10DABI	9" - 10" / 225 - 250mm	0.00005" / 0.001mm	\$787.72	<del>\$708.94</del>
MW203-11DABI	10" - 11" / 250 - 275mm	0.00005" / 0.001mm	\$807.25	<del>\$726.53</del>
MW203-12DABI	11" - 12" / 275 - 300mm	0.00005" / 0.001mm	\$869.20	<del>\$782.28</del>

## Moore & Wright External Micrometer Set

### Features:

- Standard: DIN 863
- Tungsten carbide measuring faces
- Satin-chrome scale
- Constant force ratchet on thimble
- Adjusting key
- Supplied with setting standards
- Supplied in wooden box
- 3 Micrometers in set



Part No.	Range	Resolution	List Price	Sale Price
Metric				
MW215-01BL	0-75mm	0.0005" / 0.01mm	\$272.28	<del>\$245.05</del>
Imperial				
MW215-01BLI	0-3"	0.0005" / 0.01mm	\$247.09	<del>\$222.38</del>

# Moore & Wright Dial Indicator With Lug Back

## Features:

- Standard: ANSI B89.1.10
- Aluminium body
- With tungsten carbide contact point
- Adjustable bezel with stop screw
- Tolerance indicators
- Lug back (flat back is optional)



MW401-02



Part No.	Range	Resolution	List Price	Sale Price
MW401-02	0" - 1"	0.001"	\$60.08	<b>\$54.07</b>
MW401-05	0" - 1"	0.001"	\$152.62	<b>\$137.36</b>

# Moore & Wright Dial Test Indicator

## Features:

- Automatic reversal of measuring direction
- High precision fully jewelled bearings
- Rotating dial
- Two dovetail clamps



MW420-031



Part No.	Range	Dial Diameter	List Price	Sale Price
MW420-031	0.030"	1"	\$125.26	<b>\$112.73</b>
MW420-041	0.030"	1-1/2"	\$125.88	<b>\$113.29</b>

# Moore & Wright Micrometer, Vernier, Caliper & Rule Set

## Features:

- Tungsten carbide measuring faces
- Hammertone finish frame with insulated grip
- Tapered for easier access to difficult areas
- Locking lever, constant force ratchet
- Supplied in plastic case, adjusting key
- Includes: MW200-011 micrometer; MW143-15 dial caliper; ER106F 6"/152 mm rule



Part No. MW200-SET021

**Sale \$163.52**

List Price \$181.69



## Moore & Wright Internal Digitronic Caliper

### Features:

- Large LCD display
- 0.0002" / 0.005mm resolution
- Preset capability
- Direct Inch/Metric conversion
- Absolute / Incremental measurements



MW432-01DC



Part No.	Range	List Price	Sale Price
MW432-01DC	0.2" - 0.6"/5 - 15mm	\$370.83	<b>\$333.75</b>
MW432-02DC	0.4" - 0.8"/10 - 20mm	\$405.10	<b>\$364.59</b>
MW432-03DC	0.8" - 1.2"/20 - 30mm	\$411.36	<b>\$370.22</b>
MW432-04DC	1.2" - 1.6"/30 - 40mm	\$423.73	<b>\$381.36</b>
MW432-05DC	1.6" - 2.0"/40 - 50mm	\$410.62	<b>\$369.55</b>

## Moore & Wright External Digitronic Caliper

### Features:

- Large LCD display
- 0.0002" / 0.005mm resolution
- Preset capability
- Direct Inch / Metric conversion
- Absolute / Incremental measurements

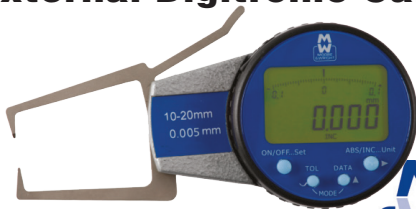

MW442-02DC



Part No.	Range	List Price	Sale Price
MW442-01DC	0.2" - 0.6"/5 - 15mm	\$390.10	<b>\$351.09</b>
MW442-02DC	0.4" - 0.8"/10 - 20mm	\$435.48	<b>\$391.93</b>
MW442-03DC	0.8" - 1.2"/20 - 30mm	\$416.33	<b>\$374.70</b>
MW442-04DC	1.2" - 1.6"/30 - 40mm	\$367.51	<b>\$330.76</b>
MW442-05DC	1.6" - 2.0"/40 - 50mm	\$444.84	<b>\$400.35</b>

## Moore & Wright Telescopic Gauge Set

### Features:

- For quick inside measurement and determination of inside diameters
- Spring loaded plunger that expands in the bore or groove
- Satin chromed body
- With auto extension and direct locking
- Measuring faces are hardened and micro-lapped

### Range:

- 8-12.7mm
- 12.7-19mm
- 19-32mm
- 32-54mm
- 54-90mm
- 90-150mm



Part No. MW315-01

**Sale \$77.27**

List Price \$85.85

# Moore & Wright Bore Gauge Setting Master Kit

## Features:

- Bore Gauge Setting Master Kit for accurately setting any bore gauge up to 6"/160mm in diameter to an accuracy of 0.0005"/0.01mm
- Setting master and 33 piece metric gauge block set supplied in aluminium case



Part No. MW720-01

**Sale \$752.<sup>39</sup>**

List Price \$835.99

# Moore & Wright Traditional Combination Set

## Features:

- Fully hardened and tempered precision rules with deeply etched graduations on both sides for ease of reading and long life
- Fully hardened and ground datum faces to resist wear
- Centrally mounted protractor vial allows unrestricted viewing
- Protractor has full 360-degree scale plate, graduated 0-180-degree
- Satin chrome scale plate on the protractor
- Unique rule clamp allows positive location and clamping
- Square head offers the following fixed angles: 15, 30, 45, 60, 75 and 90 degree
- Full set includes 12"/ 300mm rule, Protractor head, Square head & Centre head



Part No. CSME12

**Sale \$270.<sup>41</sup>**

List Price \$300.45

## Moore & Wright Traditional Vee Blocks & Clamps

### Features:

- Precision Vee Blocks
- Manufactured to BS3731 grade B
- Manufactured from case hardened and ground mild steel
- Supplied in matched pairs only
- Two malleable iron clamps with steel screws supplied with each pair of blocks
- Accuracy: 0.004"
- Range: 1"
- Width: 1¼"
- Length: 1½"
- Height: 1¼"



Part No. 231

**Sale \$235.48**

List Price \$261.64

## Moore & Wright Traditional Internal Micrometer

### Features:

- Standard: BS959
- Supplied with measuring head, extension rods and spacing collar for alternative measuring ranges
- Smaller models have detachable extension handles (901, 902 & 903)
- All models supplied in a fitted case



901



Part No.	Range	Head Range	List Price	Sale Price
901	1" - 2"	0.25"	\$456.70	<b>\$411.03</b>
902	2" - 8"	0.50"	\$583.88	<b>\$525.49</b>
903	2" - 12"	0.50"	\$725.89	<b>\$653.30</b>

## Moore & Wright Scriber

### Features:

- Pocket clip
- Pearl-chrome finish
- Carbide tipped
- Retail pack
- 140mm



Part No. **SCT001XR**

**Sale \$10.80**

List Price \$12.00

## Moore & Wright Scriber

### Features:

- Fixed carbide tipped scribe
- Pocket clip
- Pearl-chrome finish
- Robust design
- 150mm



Part No. **SCT002R**

**Sale \$4.91**

List Price \$5.45

## Moore & Wright Feeler Strip Sets

### Features:

- 20 piece feeler strip in wallet
- Nominal thickness is marked on each strip
- Imperial Set: Length 6", Range 1-25 Thou

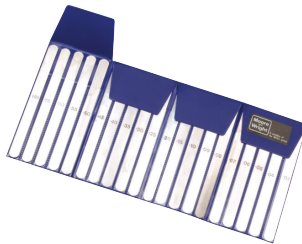

Part No. **FS20E**

**Sale \$23.99**

List Price \$26.65

Prices & Specifications are subject to change without notice.

# Sylvac Hi\_Cal V2 Digital Height Gauges

For your finer, more delicate parts.



**3 YEAR WARRANTY**



830.0156



830.0306



830.0456

## Features:

- **Bluetooth for quick, easy recorded measurements**
- Extra low measuring force, from 0.2N
- Measure internal and external diameters, centerlines, heights, widths, depths and MIN/MAX/TIR capability
- Excellent repeatability thanks to the motorized carriage
- High reliability
- Bluetooth, USB and RS232 data outputs
- Battery life: 40 hours rechargeable during operation
- Touch sensitive probe speed for easy operation
- Base with small footprint
- Includes: protective cover, charging set, ruby ball probe Ø3mm, setting gauge and calibration certificate

## Full Probe Set



930.2150

## Basic Probe Set



930.2151

Part No.	Range	Accuracy	List Price	Sale Price
830.0156	6"/150mm	0.00013"/0.0034mm	\$6,949.72	<b>\$6,602.23</b>
830.0306	12"/300mm	0.00016"/0.0042mm	\$7,358.53	<b>\$6,990.60</b>
830.0456	17.5"/450mm	0.00020"/0.005mm	\$8,584.95	<b>\$8,155.70</b>
Accessories				
930.2150	Full Probe Set		\$1,868.36	<b>\$1,774.94</b>
930.2151	Basic Probe Set		\$1,247.18	<b>\$1,184.82</b>

# Sylvac Digital Indicators

## Features:

- IP54 protected against fluid and dust
- Repeatability: 2µm
- Output: Proximity/Power - USB/RS232/digimatic/Wireless
- Menus customizable with free software
- Wide range of functions (MIN/MAX/DELTA, TOL, Factor, Preset, Auto Off, etc)
- Bezel rotates 270°
- Large display with LED tolerance indicators



805.5301.10



Part No.	Range	Accuracy	Resolution	List Price	Sale Price
805.5201.10	0 - 0.500"/12.5mm	0.0004"/0.01mm	0.0005"/0.01mm	\$821.69	<b>\$780.61</b>
805.5301.10	0 - 0.500"/12.5mm	0.00012"/0.003mm	0.00005"/0.001mm	\$1,026.22	<b>\$974.91</b>
805.5401.10	0 - 1"/25mm	0.0004"/0.01mm	0.0005"/0.01mm	\$985.31	<b>\$936.04</b>
805.5501.10	0 - 1"/25mm	0.00016"/0.004mm	0.00005"/0.001mm	\$1,189.83	<b>\$1,130.34</b>
805.5621.10	0 - 2"/50mm	0.00019"/0.005mm	0.00005"/0.001mm	\$1,637.36	<b>\$1,555.49</b>
Bluetooth					
805.6301.10	0 - 0.500"/12.5mm	0.00012"/0.003mm	0.00005"/0.001mm	\$1,191.03	<b>\$1,131.48</b>
805.6501.10	0 - 1"/25mm	0.00016"/0.004mm	0.00005"/0.001mm	\$1,416.00	<b>\$1,345.20</b>
Accessories					
981.7132	Sylcom Basic Data Processing Software			\$1,368.86	<b>\$1,300.42</b>
981.7100	USB Bluetooth Receiver			\$173.24	<b>\$164.58</b>
805.0213	Lug Back for Digital Indicators			\$119.10	<b>\$113.15</b>

# Sylvac S\_Dial Mini Bluetooth Indicators

## Features:

- Compact, small diameter (Ø45 mm)
- Water and coolant resistant, protection rating IP54 or IP67 according to IEC 60529 (depends on model)
- Data output RS 232 combined with external power supply and Bluetooth® (depends on model)
- Interchangeable contact point M2.5
- Clamping stem Ø 8-h6 of hardened and ground stainless steel
- Min/max/delta display
- Multiplication factor
- Automatic power shut down



805.6121.10



Part No.	Descriptions	Range	Resolution	List Price	Sale Price
805.6121.10	With lifting cap	0.500"/12.5mm	0.0005"/0.01mm	\$711.32	<b>\$675.75</b>
805.6521.10	With lifting cap	0.500"/12.5mm	0.00005"/0.001mm	\$959.72	<b>\$911.73</b>

# Sylvac Digital Indicator S\_Dial MINI Basic

## Features:

- Compact, small diameter (Ø45 mm)
- Improved mechanical design
- Water and coolant resistant, protection rating IP54 or IP67 according to IEC 60529 (depends on model)
- Data output RS 232 combined with external power supply and Bluetooth® (depends on model)
- Interchangeable contact point M2.5
- Clamping stem Ø 8-h6 of hardened and ground stainless steel. Dovetail back
- Automatic power shut down



805.4125



Part No.	Range	Resolution	List Price	Sale Price
805.4121	0.500" / 12.5mm	0.0005" / 0.01mm	\$574.93	<b>\$546.18</b>
805.4125	0.500" / 12.5mm	0.0005" / 0.01mm	\$593.65	<b>\$563.97</b>
805.4521	0.500" / 12.5mm	0.00005" / 0.001mm	\$805.94	<b>\$765.64</b>
805.4525	0.500" / 12.5mm	0.00005" / 0.001mm	\$842.92	<b>\$800.77</b>

# Sylvac Digital Test Indicators

## Features:

- Bluetooth connectivity to your phone or tablet
- IP65 protected against fluid and dust
- 4 measuring modes: Min, Max, TIR and Direct
- 4 measuring resolutions - 0.00005"/0.001mm or 0.0005"/0.01mm
- 1-1/2" diameter dial face rotates a full 360°
- Analog scale for reversal point indication
- Meets or exceeds DIN/ISO Standards (Maximum error on 0.00005" scale at full range: 0.0004")



805.4321.10



Part No.	Range	Contact Point Length	List Price	Sale Price
805.4321.10	0.030"/0.80mm	1/2"	\$830.59	<b>\$789.06</b>
805.4322.10	0.080"/2.0mm	1-7/16"	\$1,176.98	<b>\$1,059.28</b>
805.4323.10	0.030"/0.80mm	1/2"	\$1,284.62	<b>\$1,156.16</b>
	0.080"/2.0mm	1-7/16"		
Accessories				
981.7132	Sylcom Basic Data Processing Software		\$1,368.86	<b>\$1,300.42</b>
981.7100	USB BT Receiver		\$173.24	<b>\$164.58</b>

# Sylvac Digital Indicator S\_Dial WORK

26.1

## Features:

- Special version for cylindrical bore gauges
- Data output Power, Proximity & Bluetooth® Introduction of the Preset value on the saved Min value
- Quick measure of the reversal point
- Robust construction Water and coolant resistant
- Broad choice of functions (MIN/MAX/DELTA, TOL, PRESET, AUTO OFF, etc.)
- Automatic wake-up and sleeping mode, Absolute System S.I.S\*
- Measuring range: 0.500" / 12.5mm
- Resolution: 0.00005" / 0.001mm



Part No. 805.6317.10

**Sale \$1,116.<sup>67</sup>**

List Price \$1,175.44

# Sylvac Digital indicator S\_Dial WORK PLC

## Features:

- Max. error 4µm for 0.500" / 12.5mm
- Resolution 0.0005"/0.00005" (0.01/0.001mm)
- Low measuring force
- Powered by PLC (9...24VDC)
- With PLC connector & RS485, RS232/USB Proximity
- Clamping diameter 8h6 mm



Part No.	Range	Resolution	List Price	Sale Price
805.7201.10	0" - 0.500" / 0-12.5mm	0.0005" / 0.01mm	\$1,099.59	<b>\$1,044.61</b>
805.7301.10	0" - 0.500" / 0-12.5mm	0.00005" / 0.001mm	\$1,402.77	<b>\$1,332.63</b>
805.7401.10	0" - 1" / 0-25mm	0.0005" / 0.01mm	\$1,235.54	<b>\$1,173.76</b>
805.7501.10	0" - 1" / 0-25mm	0.00005" / 0.001mm	\$1,508.64	<b>\$1,433.21</b>

Prices & Specifications are subject to change without notice.

21

Sylvac

TOOLS NORTH AMERICA INC  
**ECLIPSE**

## Sylvac Professional Micrometer S\_Mike PRO

### Features:

- IP Rating: IP67 water protected for heavy-duty work with coolants and lubricants, according to IEC60529, with or without connector
- Data output: Bluetooth
- mm/inch conversion
- Standards met: DIN863
- Automatic wake-up by moving the measuring spindle
- Sleep mode after 20 min. of no use
- Position memorized in sleep mode
- Non-rotating spindle
- Measuring range: 0" - 1" / 0 - 30mm



Part No. 803.0306

**Sale \$907.<sup>07</sup>**

List Price \$954.81

## Sylvac Digital Thickness Feeler Gauge

### Features:

- Large digital display
- Built-in Bluetooth® 4.0 transmitter (HID)
- Powered by standard CR2032 battery
- Battery life up to 1 year
- No software, driver or dongle needed with HID
- Measurement capacity: 0.001" - 0.05" / 0.04 - 1.00mm
- Number of feelers: 19



Part No. 921.0110.10

**Sale \$789.<sup>06</sup>**

List Price \$830.59

## Sylvac Lever Probe LPD and LPD Smart

### Features:

- Lever probe with direct digital output
- Instrument for checking linear and circular geometry
- M2 stylus with Ø 3 mm tungsten carbide ball, swivelling and interchangeable
- Model with Bluetooth® technology (801.3006)
- Model with direct output USB (801.3012)



Part No.	Range	List Price	Sale Price
801.3006	+0.02"/0.05" / +0.6 /+1.3mm	\$2,175.36	<b>\$2,066.59</b>
801.3012	+0.02"/0.05" / +0.6 /+1.3mm	\$1,614.53	<b>\$1,533.80</b>

# Sylvac Swiss Digital Calipers

3 styles to suit your needs.

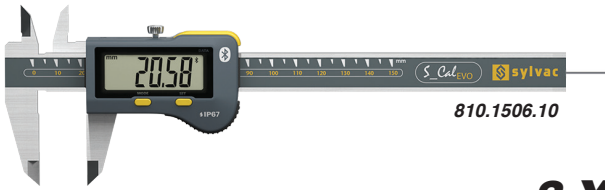

810.1506.10

## Features:

- IP67 protected against fluid and dust
- Available with Bluetooth, proximity cable or no SPC output
- Heavy duty frame
- Extra large display
- Available with ISO Cert
- 12"/300mm is supplied without depth rod

**3 YEAR WARRANTY** ✓



**Calibration certificates available for all sizes.**

Part No.	Range	Accuracy	Resolution	List Price	Sale Price
<b>Bluetooth Communication</b>					
810.1506.10	6"/150mm	0.0008"/20µm	0.0005"/0.01mm	\$507.70	<b>\$482.32</b>
810.1526.10	8"/200mm	0.0012"/30µm	0.0005"/0.01mm	\$763.94	<b>\$725.74</b>
810.1536.10	12"/300mm	0.0012"/30µm	0.0005"/0.01mm	\$944.40	<b>\$897.18</b>
<b>Without Data Output</b>					
810.1502.10	6"/150mm	0.0008"/20µm	0.0005"/0.01mm	\$270.69	<b>\$257.16</b>
810.1522.10	8"/200mm	0.0012"/30µm	0.0005"/0.01mm	\$434.30	<b>\$412.59</b>
810.1532.10	12"/300mm	0.0012"/30µm	0.0005"/0.01mm	\$590.70	<b>\$561.17</b>
<b>Connectivity Cables/Accessories</b>					
981.7132	Sylcom Basic Data Processing Software			\$1,368.86	<b>\$1,300.42</b>
926.6721.10	Proximity cable with USB Connection			\$257.15	<b>\$244.29</b>
926.6723	Proximity cable with Serial Connection			\$255.63	<b>\$242.85</b>
981.7100	USB Bluetooth Receiver			\$173.24	<b>\$164.58</b>

# Sylvac SCAN S25T

Fast, Accurate, Reliable & Repeatable!

## Features:

- Ideal for small cylindrical parts
- Measuring range: 1.02"/26mm Diameter, 7.87"/200mm Length
- High resolution and high accuracy
- One-click rapid measuring
- 30° tilting optics for complete thread measurements



Automation



**Super fast**

Precise measurement of small cylindrical parts in only a few seconds.



**Easy to use**

With one click measurement.



**Save money**

Quick ROI, reduced inspection time and increased productivity.

**Call the Sales Team at Eclipse Tools NA Inc. for pricing! 1-800-260-2124**

Part No. 902.4025

Prices & Specifications are subject to change without notice.

23

26.1

Sylvac

ECLIPSE  
TOOLS NORTH AMERICA INC.

## Trimos V Series Digital Height Gauges

The Trimos V series vertical measuring instruments have been developed for the most difficult shop floor environments. Manufactured in Switzerland, they guarantee precise and repeatable measurements with superior ease of use.

### Features:

- Electronically adjustable measuring force 0.75/1.5 (N)
- Lithium-ion rechargeable batteries last up to 40 hours
- Bluetooth transmitter available

### All models include:

- Charging unit
- Measuring probe with ruby ball Ø4mm
- Probe holder elbow Ø 8mm
- Setting gauge
- User's manual and calibration certificate



*Measures ID/OD, centerlines, heights, widths, depths, min/max/delta, slots, grooves and more!*

V9-700

# V-Series Electronic Height Gauges Comparison Chart

26.1

	V9	V4	V3/V2
<b>Accuracy</b>			
1.2 + L(mm)/1000 µm	✓		
2 + L(mm)/400 µm			
2.5 + L(mm)/300 µm			
4.5 - 6 µm		✓	
7 - 8 µm			✓
<b>Range</b>			
400/700mm	✓	✓	✓
1100mm	✓		
<b>Smart Reverse for Ø</b>	✓	✓	✓
<b>Air Cushion</b>	✓	✓	
<b>Wireless Option</b>	✓	✓	
<b>Manual/Motorized</b>	✓		
<b>Manual ONLY</b>		✓	✓
<b>Fine Adjustment</b>			
<b>Color Display</b>	✓		
<b>2D Measuring</b>	✓		

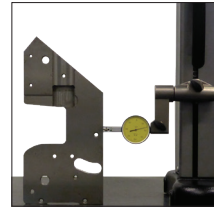
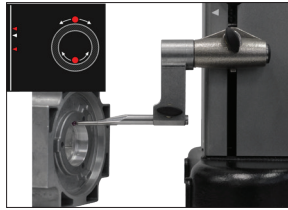
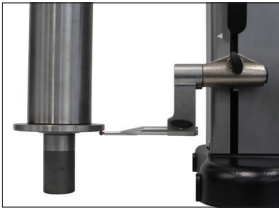

Trimos

Part No.	Range	List Price	Sale Price
V2			
V2-400	16"/407mm	\$6,237.00	<b>\$5,925.15</b>
V2-700	28"/711mm	\$7,389.94	<b>\$7,020.44</b>
V3			
V3-400	16"/407mm	\$6,915.18	<b>\$6,569.42</b>
V3-700	28"/711mm	\$7,663.49	<b>\$7,280.32</b>
V4			
V4-400	16"/407mm	\$8,563.39	<b>\$8,135.22</b>
V4-700	28"/711mm	\$9,871.10	<b>\$9,377.55</b>
V9			
V9-400	16"/407mm	\$17,426.34	<b>\$16,555.02</b>
V9-700	28"/710mm	\$18,442.92	<b>\$17,520.77</b>
<b>Probe Sets</b>			
TA-SE-105	4mm Probe Set, 21 piece	\$3,108.20	<b>\$2,681.54</b>
TA-SE-106	8mm Probe Set, 16 piece	\$2,316.52	<b>\$1,999.98</b>
TA-SE-107	8mm Basic Probe Set, 7 piece	\$896.97	<b>\$774.62</b>
<b>Accessories</b>			
TA-IH-127	12"/300mm Holder - for 8mm probes	\$1,782.09	<b>\$1,692.99</b>
TA-EL-022	Bluetooth transmitter (Not available for V3 models)	\$1,058.12	<b>\$1,005.21</b>
981.7161.10	Vmux software - for connecting multiple units to one PC	\$666.89	<b>\$633.55</b>

## Trimos Height Gauge V1 & V1+

Tough gauge for the modern workshop!



### Features:

- Robust and Easily Portable
- Clear, Simple User Interface
- Counterweight for Operational Comfort
- Quick and Smooth Carriage movement
- Designed and manufactured in Switzerland
- Bidirectional Measurement Capability (V1+)
- Measuring Force Management (V1+)

 **TRIMOS**

 **SWISS  
MADE**

Part No.	Range	Resolution	List Price	<i>Sale Price</i>
V1				
V1-300	12"/300mm	0.0005"/0.01mm	\$4,517.40	<b>\$3,457.71</b>
V1-600	24"/600mm	0.0005"/0.01mm	\$4,830.00	<b>\$3,998.05</b>
V1+				
V1+-300	12"/300mm	0.00005"/0.001mm	\$6,088.31	<b>\$4,449.03</b>
V1+-600	24"/600mm	0.00005"/0.001mm	\$6,459.34	<b>\$4,947.98</b>

## Trimos C4 CNC Portable Coordinate Measuring Machine

The world's first truly portable CNC Coordinate Measuring Machines designed for the workshop

### Features:

- Portable for the maximum of flexibility
- 4 axes model
- High precision using Renishaw TP20 probe
- Small foot print
- Fully CNC combined with manual operation
- Ease of use with Aberlink software
- 3D complement to the height gauge 1D/2D
- Designed for workshop operation
- Ethernet or wireless communication
- Extremely easy to set up

 **TRIMOS**

 **SWISS  
MADE**



*Call the Sales Team at Eclipse  
Tools NA Inc. for pricing! 1-800-260-2124*

# Trimos Measuring and Setting Bench HS4-500

## Features:

- Delivered with two parallel 25 mm TEL5 gauge blocks
- Robust design, ideal for use in workshop
- Very simple use
- Fast and precise checking
- Works on battery or power supply
- Measuring range: 20" / 550mm
- Maximal resolution: 0.00001" / 0.0001mm

**Set your own instruments quickly and accurately!**



*Call the Sales Team at Eclipse Tools NA Inc. for more information! 1-800-260-2124*

# Trimos Calibration Bench THV

Calibration bench for certification of equipment such as ring gauges and thread plug gauges. Its small dimensions and highly precise measuring system make it the ideal instrument for a mobile calibration station.

## Features:

- Ideal for use in a clean space in the workshop
- ISO 9000 certified
- Easy to use
- Large accessories range
- According to the application, can be set up to 90° horizontally or inclined
- Absolute measuring range: 2" / 50mm



*Call the Sales Team at Eclipse Tools NA Inc. for more information! 1-800-260-2124*

## Trimos 3D Measuring Arms

### Features:

- Extremely easy and accurate 3D measurement
- Measuring ranges 1.3m to 9m
- Portable and designed for workshop environment
- Certified according to ISO 10360-2 and ISO 10360-12
- Exist in 6 axis configuration
- Protection with electromagnetic brake
- On-site demos available
- No annual software maintenance contracts
- Free software upgrades
- Low cost of ownership
- Operational temperature: +5 ÷ +40°C
- Connectivity: Bluetooth and USB

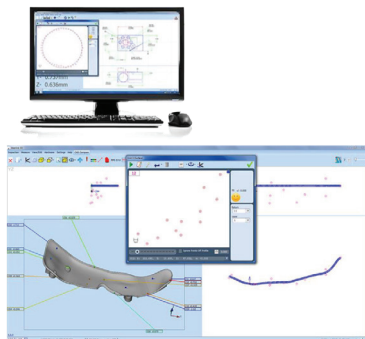

**TRIMOS**  **SWISS MADE**



Part No.	Range	Axis
A3		
A3-1300	4.3ft/1.3m	6
A3-1800	5.9ft/1.8m	6
A5		
A5-1800-WA	5.9ft/1.8m	6
A5-2500-WA	8.2ft/2.5m	6
A5-3200-WA	10.5ft/3.2m	6
A5-4000-WA	13.1ft/4.0m	6
A5-5000-WA	16.4ft/5.0m	6
A5-7000-WA	23.0ft/7.0m	6
A5-9000-WA	29.5ft/9.0m	6

### Accessories Available

Hard Probe



Mobile Tripods



Magnetic Base



Battery



**Plus More**

Call the Sales Team at Eclipse Tools NA Inc.  
for more information! 1-800-260-2124

# CV Instruments Surface Roughness Tester

## Features:

- Pocket-sized and economically priced!
- External and internal finish testing with swivable tracer
- Ra and Rz parameters in one instrument and all available after each individual test
- Standard 9V battery
- Three cut-off 0.25mm, 0.8mm and 2.5mm, adjustable to 1-3-5 times
- IPX-104 with data output



Part No. IPX-104

**Sale \$2,438.<sup>88</sup>**

List Price \$2,709.87

# CV Instruments Surface Roughness Tester

## Features:

- Large range of test parameters RX, Ra, Rz, Rq, Rt, Rp, Rv, R3z, R3y, RzJIS, Rsk, Rku, Rsm, Rmr
- 128 x 64 OLED dot matrix display, digital/graphic display; highlight no perspective
- Large memory, can store 100 groups of original data and waveform
- Display information, can display all the parameters and graphics
- Compatible with ISO, DIN, ANSI, JIS national standards
- Built-in Li-ion rechargeable battery
- Working time > 20 hours of continuous work
- Automatic shutdown and power saving function
- Connected to PC and printer



Part No. IPX-105

**Sale \$2,778.<sup>61</sup>**

List Price \$3,087.34

## 1-2-3 & 2-4-6 Blocks

Useful in layout and grinding work.

### Features:

- 23 holes for easy clamping
- Sold in pairs
- Hardened 56 - 60 HRC
- 1-2-3 blocks have 5 threaded holes, 3/8" - 16
- 2-4-6 blocks have 5 threaded holes, 5/8" - 11

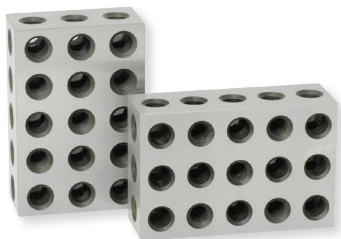

52-439-246-0

Part No.	Description	Accuracy	List Price	Sale Price
52-439-031-0	1-2-3 Blocks	± 0.0002"/1"	\$104.04	<b>\$98.84</b>
52-439-032-0	1-2-3 Blocks	± 0.0002"/1"	\$195.94	<b>\$186.14</b>
52-439-246-0	2-4-6 Blocks	± 0.0003"/1"	\$390.15	<b>\$370.64</b>

## Electronic Edge Finders

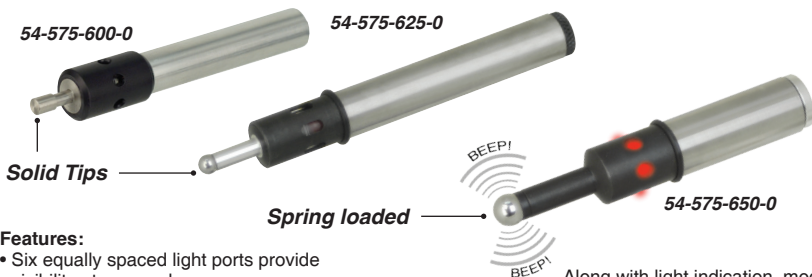

### Features:

- Six equally spaced light ports provide visibility at any angle
- Edge finder lights instantly when stylus touches work edge
- Repeatability: 0.0002"
- Works on any conductive metal

Along with light indication, model 54-575-650-0 emits an audible "beep" at time of contact with electrically conductive metal.

Part No.	Stylus	Shank	Audible	List Price	Sale Price
54-575-600-0	0.200"	1/2"	NO	\$97.54	<b>\$92.66</b>
54-575-625-0	0.200"	1/2"	NO	\$315.56	<b>\$299.78</b>
54-575-650-0	0.400"	3/4"	YES	\$315.56	<b>\$299.78</b>

## Weight & Counting Scale

### Features:

- Accurately measures weights and quantities
- Use for counting large batches of small parts
- Measure weights up to 66 lbs./30 kg.
- Removable stainless steel weighing pan and durable ABS housing
- Converts pounds, ounces, grams, kilograms
- Internal battery with 100 hours of use
- Front panel leveling indicator with adjustable leveling feet
- 3 panel backlit LCD display indicates weight, average piece weight and count



**Measures up to 66 lbs.!**

Part No. 54-750-030-0

**Sale \$435.77**

List Price \$458.70

# Outside Vernier Micrometer Set

## Features:

- Range: 0 - 6"
- Carbide tipped measuring faces
- Graduation: 0.001"
- Diameter of measuring faces: 0.256"
- Anvil & spindle hardened and precision ground with microlap finish on tips
- Sizes over 1"/25mm include a standard

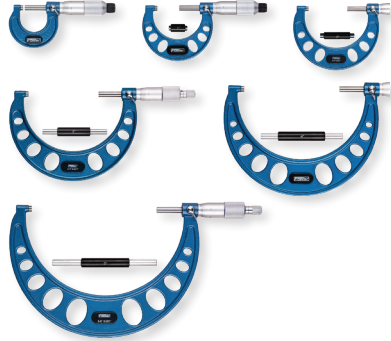

Part No. 52-253-600-1

**Sale \$881.<sup>31</sup>**

List Price \$927.69

# X-TEST®

## Horizontal & Vertical Test Indicators

### Features:

- Super smooth jeweled movement
- Smooth bezel adjustment for easy zero setting
- Solid brass anti-magnetic housing
- 0.080" and 0.120" carbide ball contact points (0.040" steel ball)
- 0.060" range with auto reverse and rev. counter
- Easy to read tilted dial
- 5/32" pivotable stem



52-562-005-0



52-562-001-0



52-562-002-BD

Part No.	Graduation	Dial Size	Dial Reading	List Price	Sale Price
Horizontal					
52-562-001-0	0.0005"	1-1/2"	0 - 15 - 0	\$253.16	<b>\$240.51</b>
52-562-001-0-BD	0.0005"	1-1/2"	0 - 15 - 0	\$275.71	<b>\$261.92</b>
52-562-002-0	0.0005"	1"	0 - 15 - 0	\$247.96	<b>\$235.56</b>
52-562-002-0-BD	0.001"	1"	0 - 15 - 0	\$289.43	<b>\$274.95</b>
52-562-003-0	0.0005"	1"	0 - 15 - 0	\$273.97	<b>\$260.27</b>
52-562-008-0	0.0005"	1-1/2"	0 - 40 - 0	\$289.58	<b>\$275.10</b>
Vertical					
52-562-004-0	0.0005"	1-1/2"	0 - 15 - 0	\$315.59	<b>\$299.81</b>
52-562-005-0	0.0005"	1"	0 - 15 - 0	\$315.64	<b>\$299.86</b>

Prices & Specifications are subject to change without notice.

# Fulcrum Revolutionary Manual CMM



## Features

- Small footprint allowing measurements right next to your machine
- Intuitive software, allows quick and easy measurement
- Minimal setup
- Programmable magnetic soft buttons allow you to quickly change between software features without using a mouse
- Magnetic fixture templates allow you to quickly fix your part
- Volumetric accuracy of 0.0002"/0.005mm
- Uses a single USB cable to connect and requires no air

**Call the Sales Team at Eclipse Tools NA Inc.  
for more information! 1-800-260-2124**

# ECLIPSE

TOOLS NORTH AMERICA INC



Follow and Like Eclipse Tools NA

